

Installation Guide

Standard Bath Front & End Panels

Parts supplied



AND / OR



1 x Bath Front Panel

1 x Bath End Panel

Tools required (not supplied)

- Tape Measure
- Pencil
- Straight Edge
- Tube of Sanitary Silicone (clear)
- Sealant Gun
- Timber Battens
- Hand Saw
- Drill (Solid walls & Floor only)
- Screwdriver
- Fixings
- Adjustable Spanner

Important Information

PLEASE READ THESE INSTRUCTIONS THOROUGHLY BEFORE STARTING INSTALLATION.

Check the pack and make sure you have all the parts listed.

- 1) Ensure that your bath is securely fixed in accordance with manufacturers instructions.
- 2) Ensure that all water connections under the bath have been checked and tested.
- 3) Ensure that all waste connections under the bath have been checked and tested.

Bath front panel are available for all straight edged baths up to 2050mm in length. The maximum height of bath panel is 600mm. Please ensure that your bath is no more than 600mm from the floor to the underside of the bath edge.

Do not put any heavy or sharp items onto the bath panels as this may damage it.

When you are ready to start, make sure that you have the right tools to hand and that the installation area is clean and dry.

When drilling or fixing into walls or floors it is essential that you check for pipes and wires before commencing.

Important Tiling Advice

It is essential that you do not use a ready mixed tile adhesive.

Flexible cement based powdered adhesive must be used with elements

Bath Front Panel Installation

Wall To Wall Installation

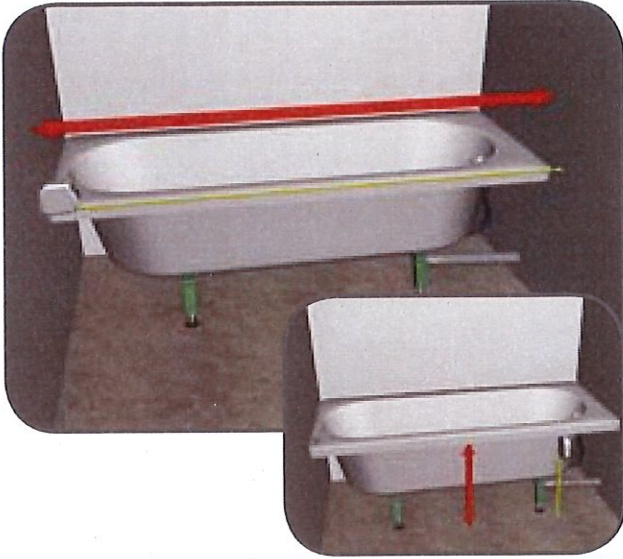

Step 1

Measure the overall length required from wall to wall. Measure the overall height from the floor to the underside of the bath. It may be that the bath panel requires no cutting to make it fit; if that is the case you can skip step 2 and/or 3.

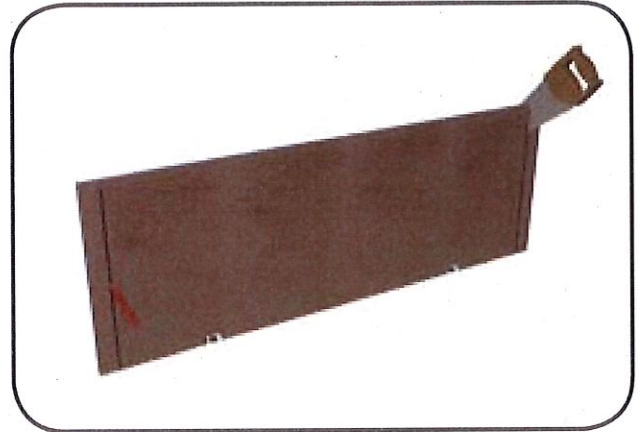

Step 2

Trimming the length of the panel

The bath panel should be cut equally from both sides so that the bath panel feet remain central. Carefully mark the cut position on either side using a pencil and straight edge. Cut the bath panel carefully using a hand point saw.

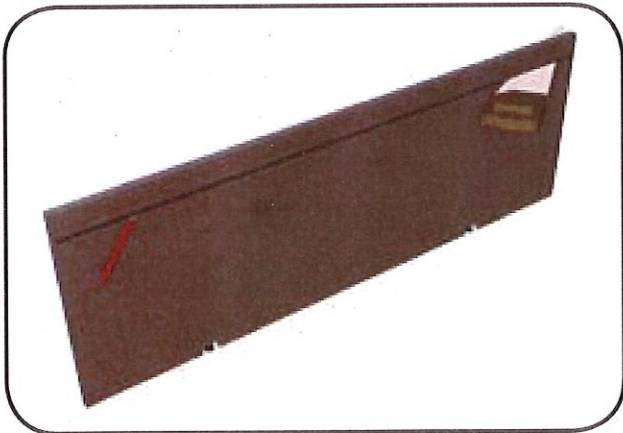

Step 3

Trimming the height of the panel

Carefully mark the cut position using a pencil and straight edge for the height of the bath panel deducting 5mm on your measurement. Ensure that you mark the top of the bath panel (the opposite end to the bath feet). Cut the bath panel carefully using a hand point saw.

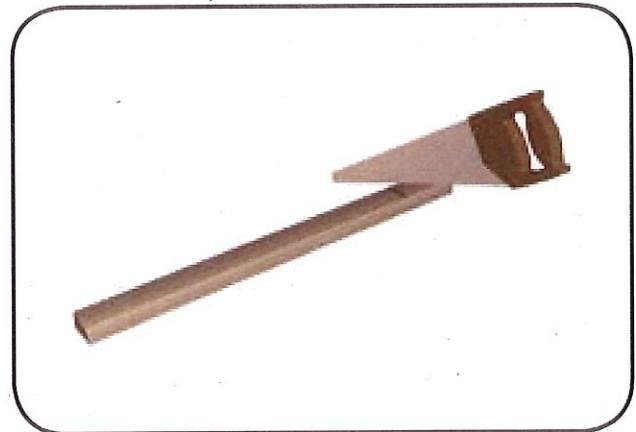

Step 4

Mark and cut two timber battens approx 500mm in length and a third batten 1250mm in length using a hand point saw.

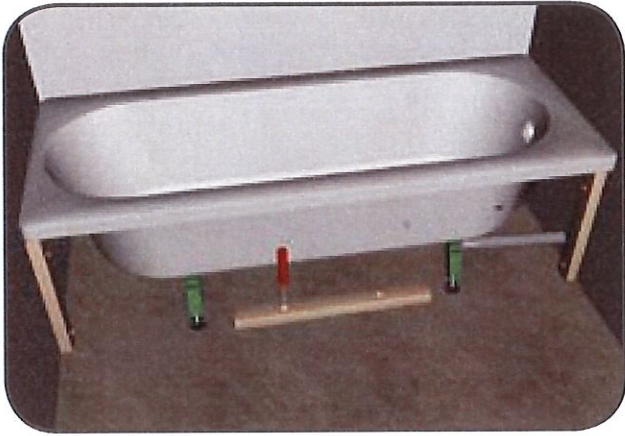

Step 5

Securely fix the two smaller battens vertically on the wall at either side of the bath and 1 larger batten horizontally on the floor, using a drill, screwdriver and appropriate fixings. They need to be positioned back from the front lip of the bath to allow for the bath panel thickness (30mm) plus the thickness of your tile & adhesive. These battens will act as supports for the panel.

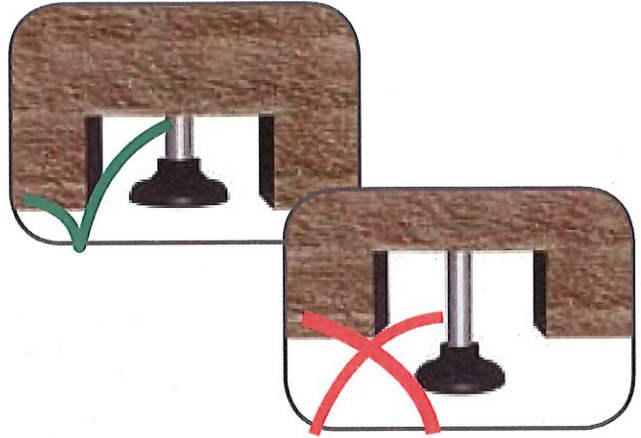

Step 6

Ensure that the bath feet are wound in so that they sit at the same level as the bath panel i.e. The bath feet are NOT extended.

**Handy Hint: Alternatively, a bath mounting kit is available to purchase separately*

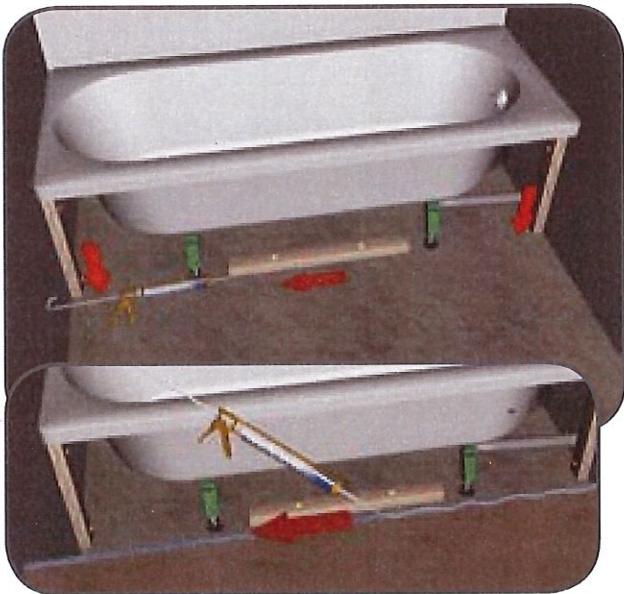

Step 7

Apply a thin bead of sanitary silicone across the front face of the battens and a thin bead across the top edge of the bath panel.

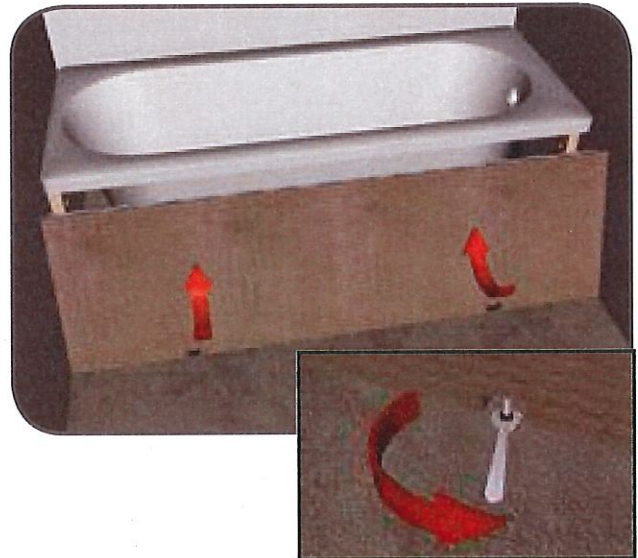

Step 8

Position the bath panel under the rim of the bath and raise the bath panel into position by turning each of the front panel feet anti-clockwise using an adjustable spanner until the top of the bath panel presses against the underside of the bath rim to give a secure fixing.

Step 9

Allow the silicone to cure prior to tiling.

Bath Front & End Panel Installation

Wall To End Panel Installation



Step 10

Measure the overall length required from wall to end of bath. Measure the overall height from the floor to the underside of the bath.

Step 11

Trimming the front and end panels & cutting the timber battens

Repeat steps 2 & 3 trimming the height and width of the front and end panels to your required sizes. Repeat step 4 cutting the timber battens but this time cut an additional small batten.



Step 12

Securely fit two small battens at either side where the bath meets a wall using a drill, screwdriver and appropriate fixings. They need to be positioned far enough away from the front lip of the bath to allow for the bath panel (30mm) plus your choice of tile and adhesive. Securely fix the large batten to the floor along the longest edge and the third small batten across the width edge, again mounting them far enough back to allow for the bath panels (30mm) plus your choice of tile & adhesive. These will act as a support for the panels.

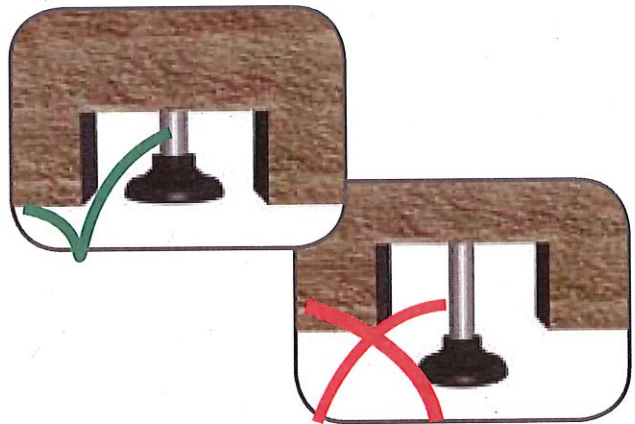

Step 13

Ensure that the bath feet are wound in so that they sit at the same level as the bath panel i.e. The bath feet are NOT extended.

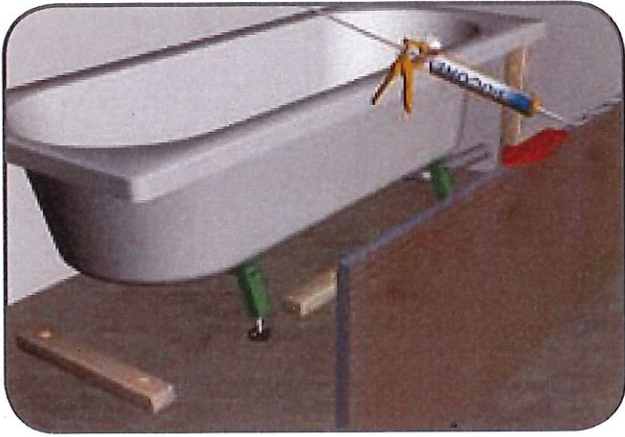

Step 14

Apply a thin bead of silicone across the front face of the battens and a thin bead across the top edge of the front panel.



Step 15

Position the front panel under the rim of the bath and raise the front panel into position, by turning each of the bath panel feet anti-clockwise using an adjustable spanner until the top of the front panel presses against the underside of the bath rim to give a secure fixing.

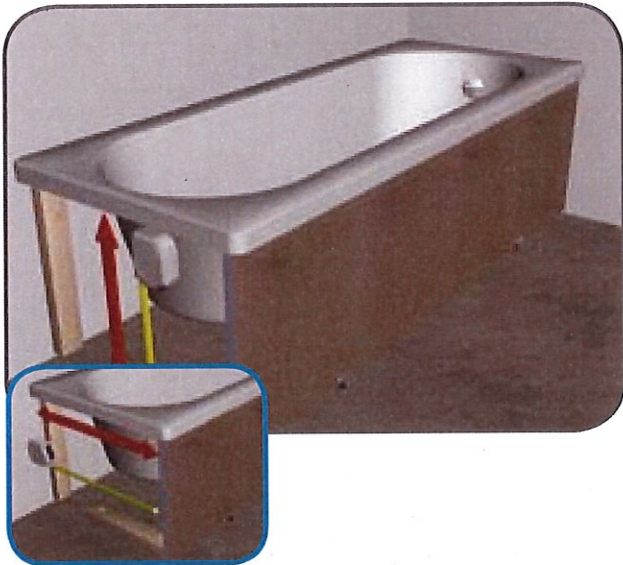

Step 16

Measure the height from the floor to the underside of the front panel and the length from wall to inside edge of the front panel you have just installed. Trim the end panel as per steps 2 & 3.

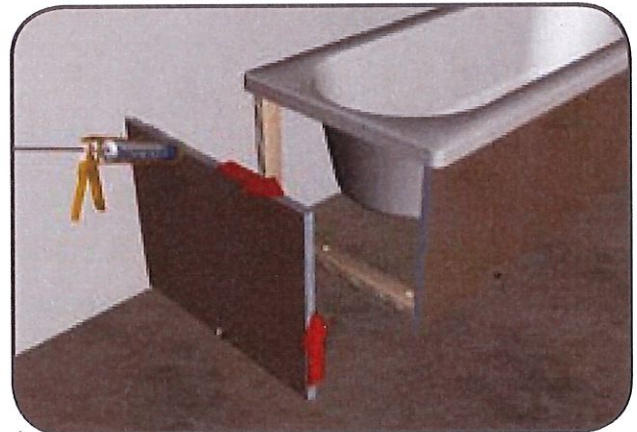

Step 17

Apply a thin bead of silicone across the top and side edge of the end panel.

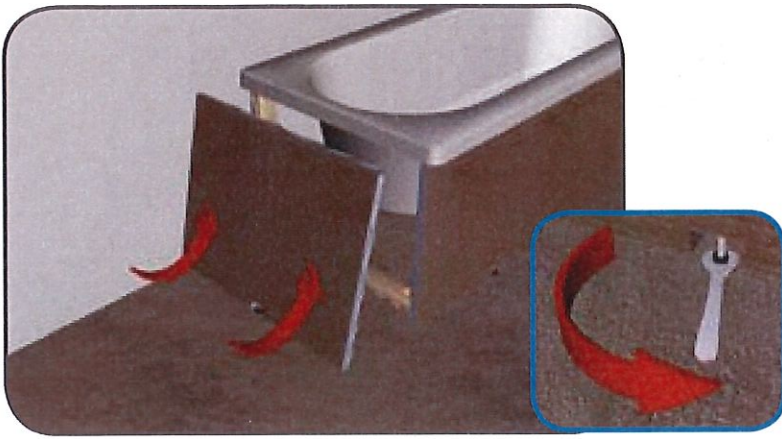

Step 18

Position the bath panel under the rim of the bath and raise the bath panel into position by turning each of the panel feet anti-clockwise using an adjustable spanner until the top of the end panel presses against the underside of the bath rim to give a secure fixing.

Step 19

Allow the silicone to cure prior to tiling.

Creating Access To The Underside Of The Bath

One of the features of this tiled bath panels is that it is quite easy to gain emergency access under the bath if required. If you require access under the bath please follow the steps below.

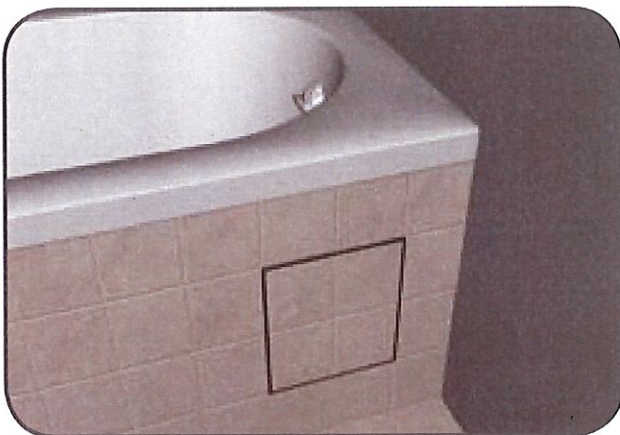

Step 1

Establish the quantity of tiles required to allow adequate access and remove the grout around the area.

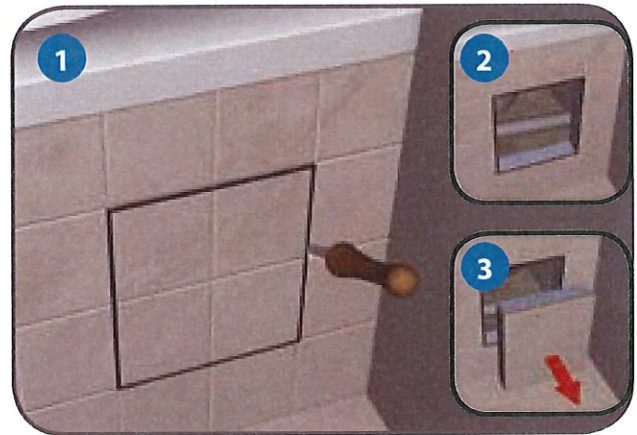

Step 2

Remove the area of tiles by carefully cutting around the grout lines with a pad saw and put them to one side.



Step 3

Apply a thin bead of silicone around the tiled area you removed earlier and carefully install back into position. Allow the silicone to cure.

Step 4

Re-grout as required.

Our liability under any guarantee expressed or implied is strictly limited to replacement of defective goods or a refund at our discretion and no consequential losses will be entertained. Proof of purchase will be required.