

NOT192

05.2026

Sanicondens Pro / Sanicondens Eco v02

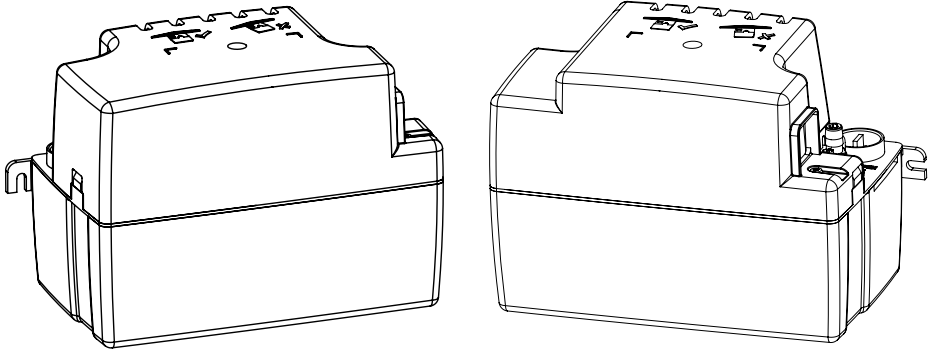

EN OPERATING/INSTALLATION MANUAL





EN • WARNING

This device can be used by children who are at least 8 years old and by people with reduced physical, sensory or mental capacities or those without knowledge or experience, if they are properly supervised or if they have been given instructions on safely using the device and the associated risks have been understood. Children should not play with the device. Children should not clean or perform maintenance on the device without supervision.

ELECTRICAL CONNECTIONS

The electrical installation must be done by a qualified electrical engineer. All wiring must conform to BS7671, 1992 requirements for electrical installations.

The device's power supply must be connected to ground (class I) and protected by a high sensitivity differential circuit breaker (30 mA). Devices without plugs must be connected to a main switch on the power supply which disconnects all poles (contact separation distance of at least 3 mm). The connection must be used exclusively to provide the power to the product. If the power cord is damaged, it must be replaced by a special cord or assembly available from the manufacturer or customer service team.

**Disconnect electrical power
before working on the unit !**

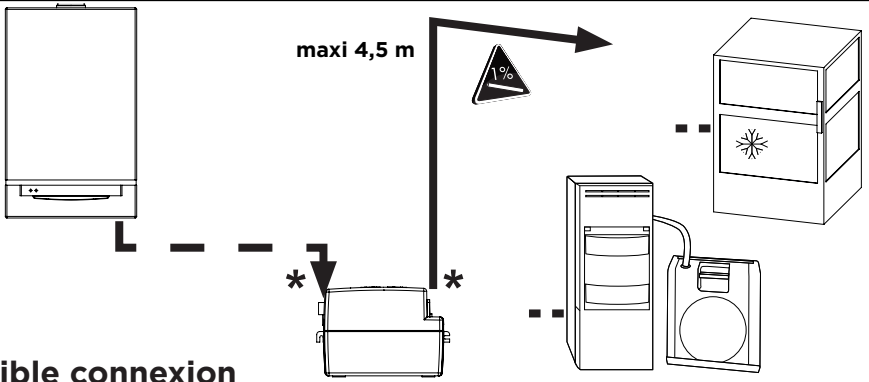

* Possible connexion

**PRO
ECO**

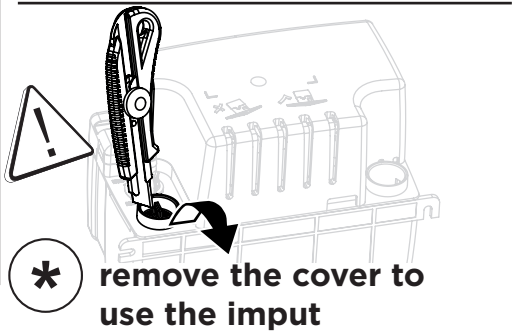
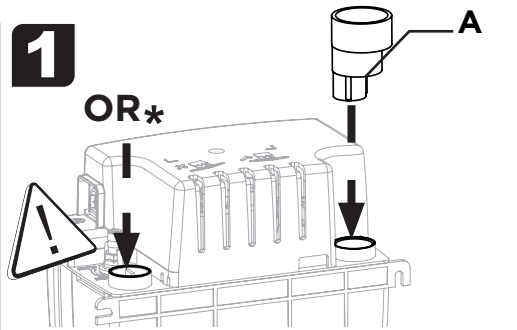
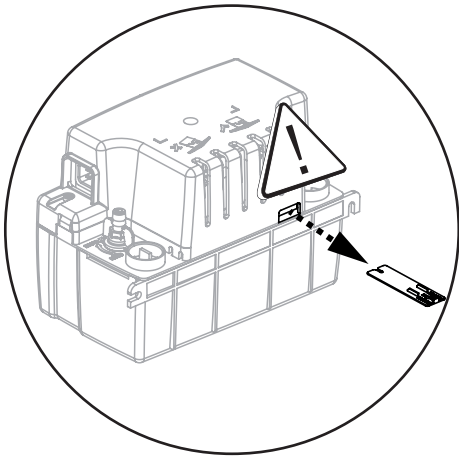
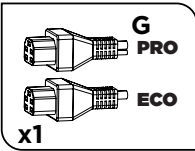
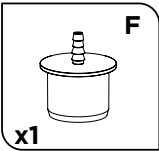
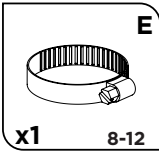
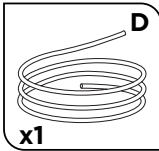
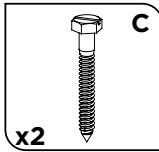
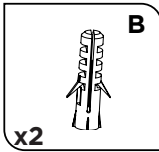
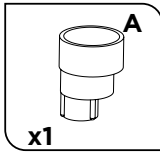

2

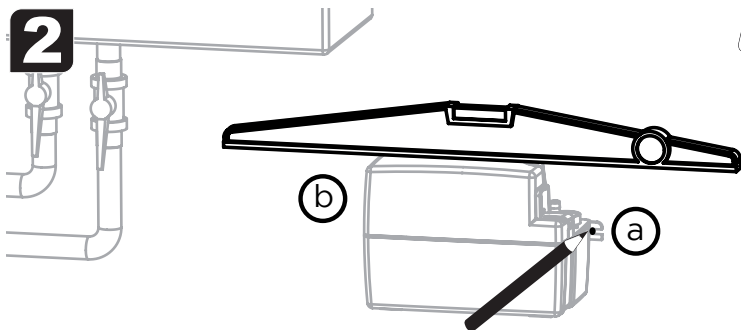

3

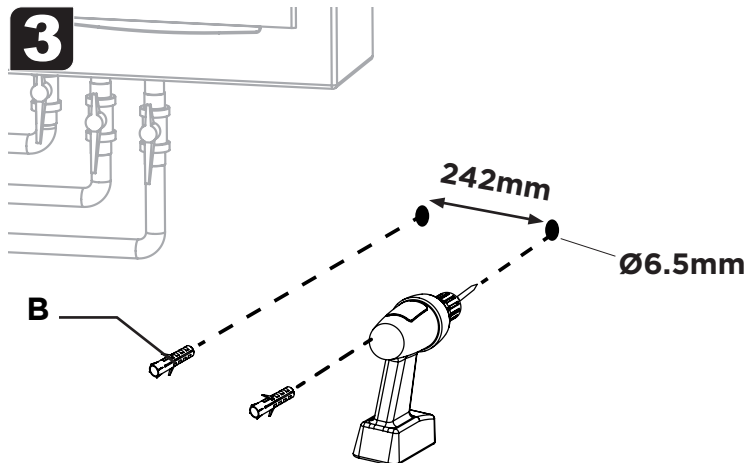

4

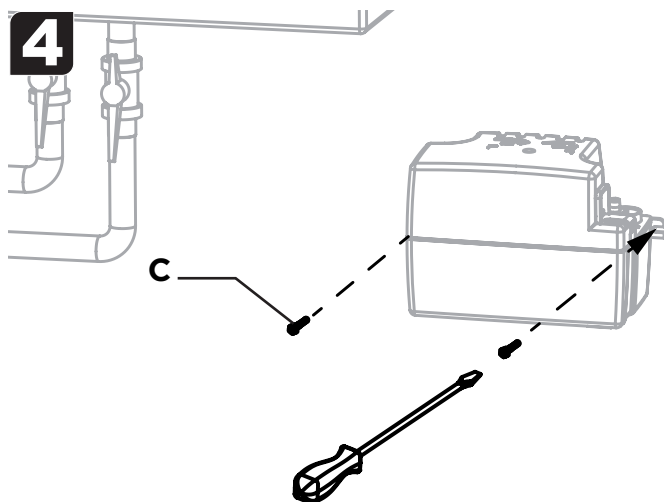

5

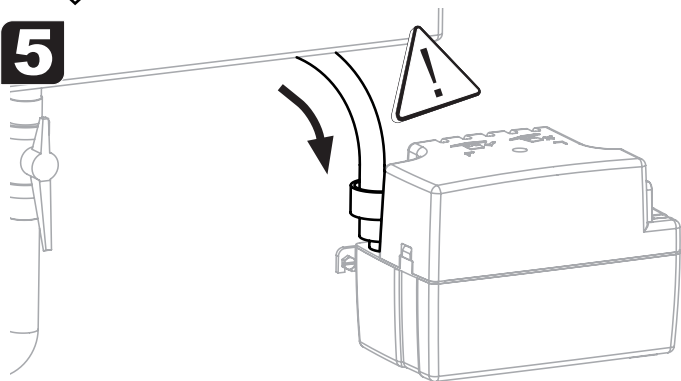

6

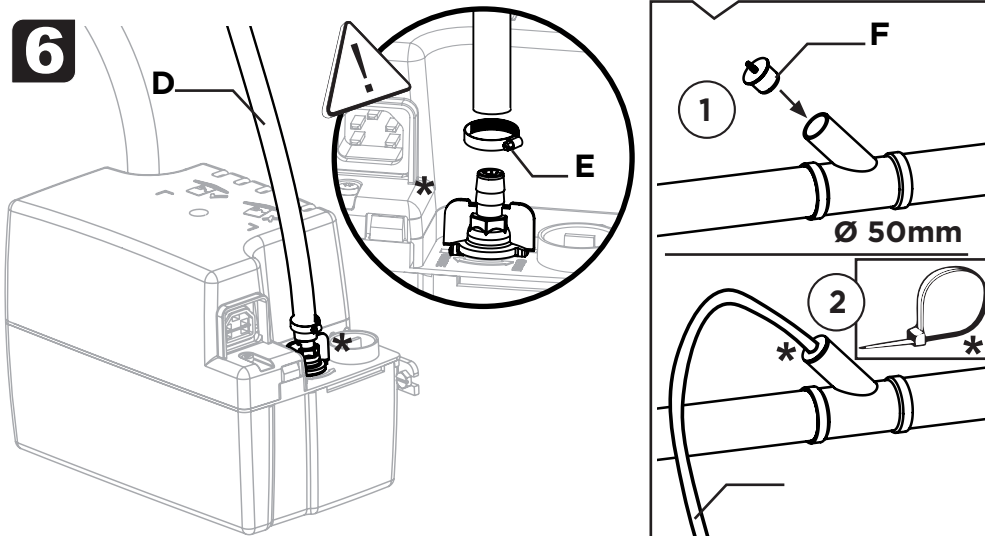

7

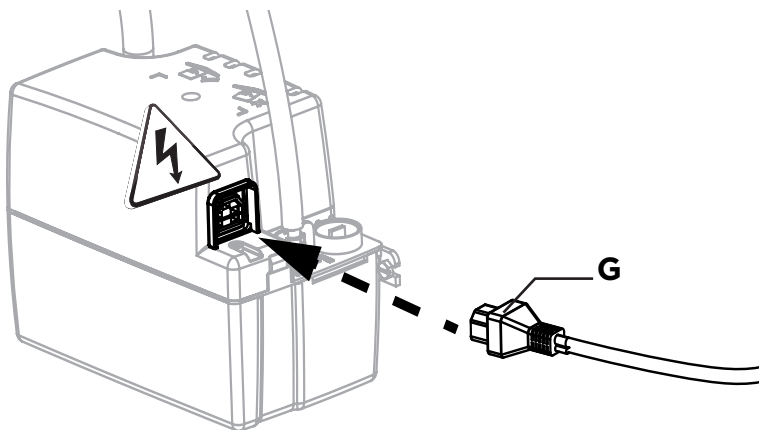

8 Sanicondens® Pro ALARM (for qualified professionals only)

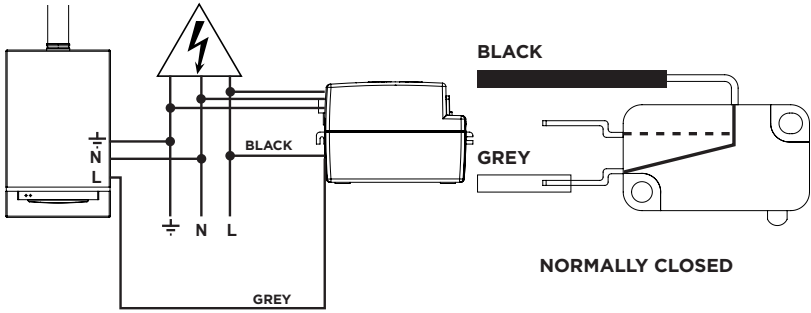

9

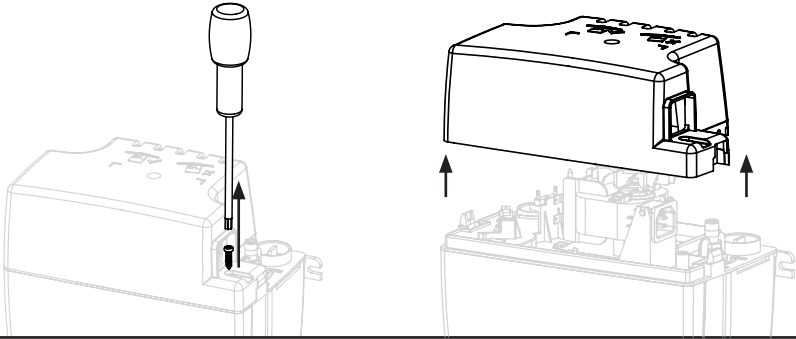

10

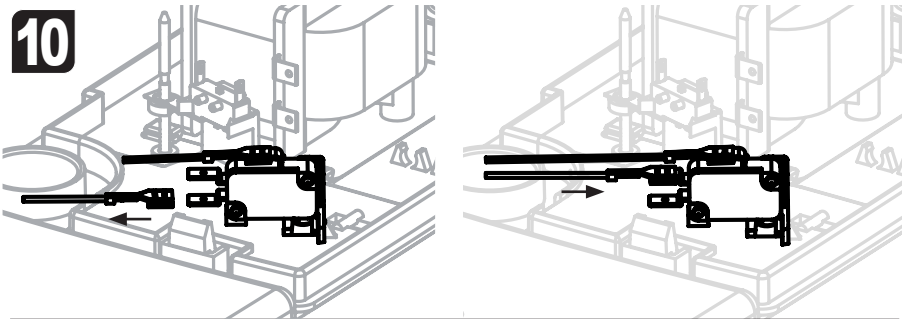

11

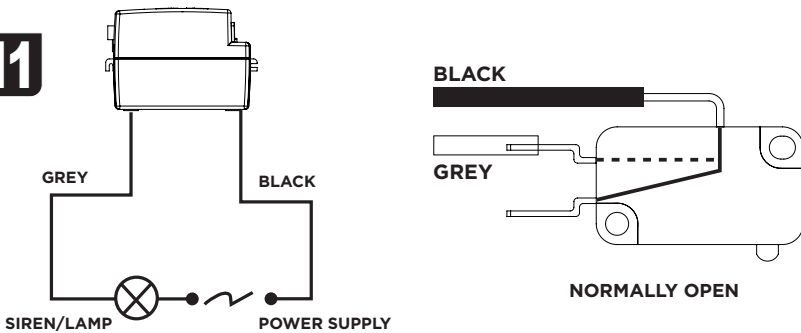

Sanicondens® Pro

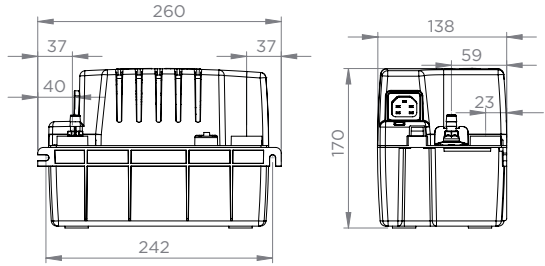

Sanicondens® Eco

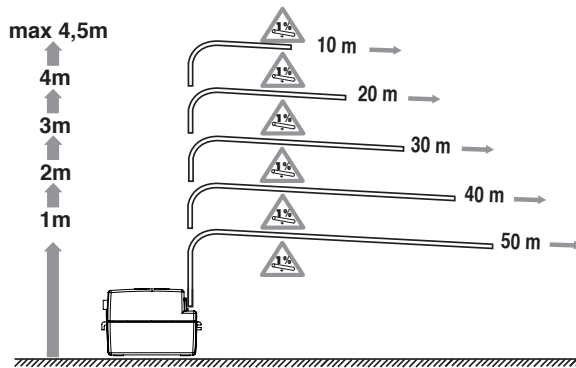
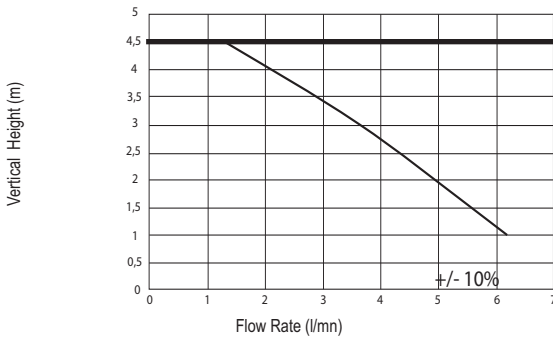
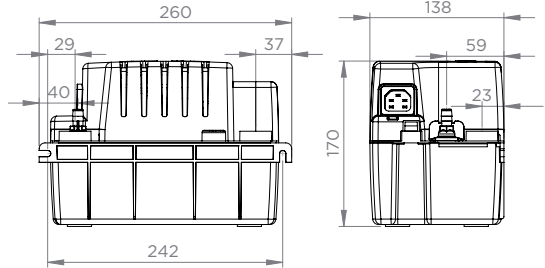

ECO

PRO

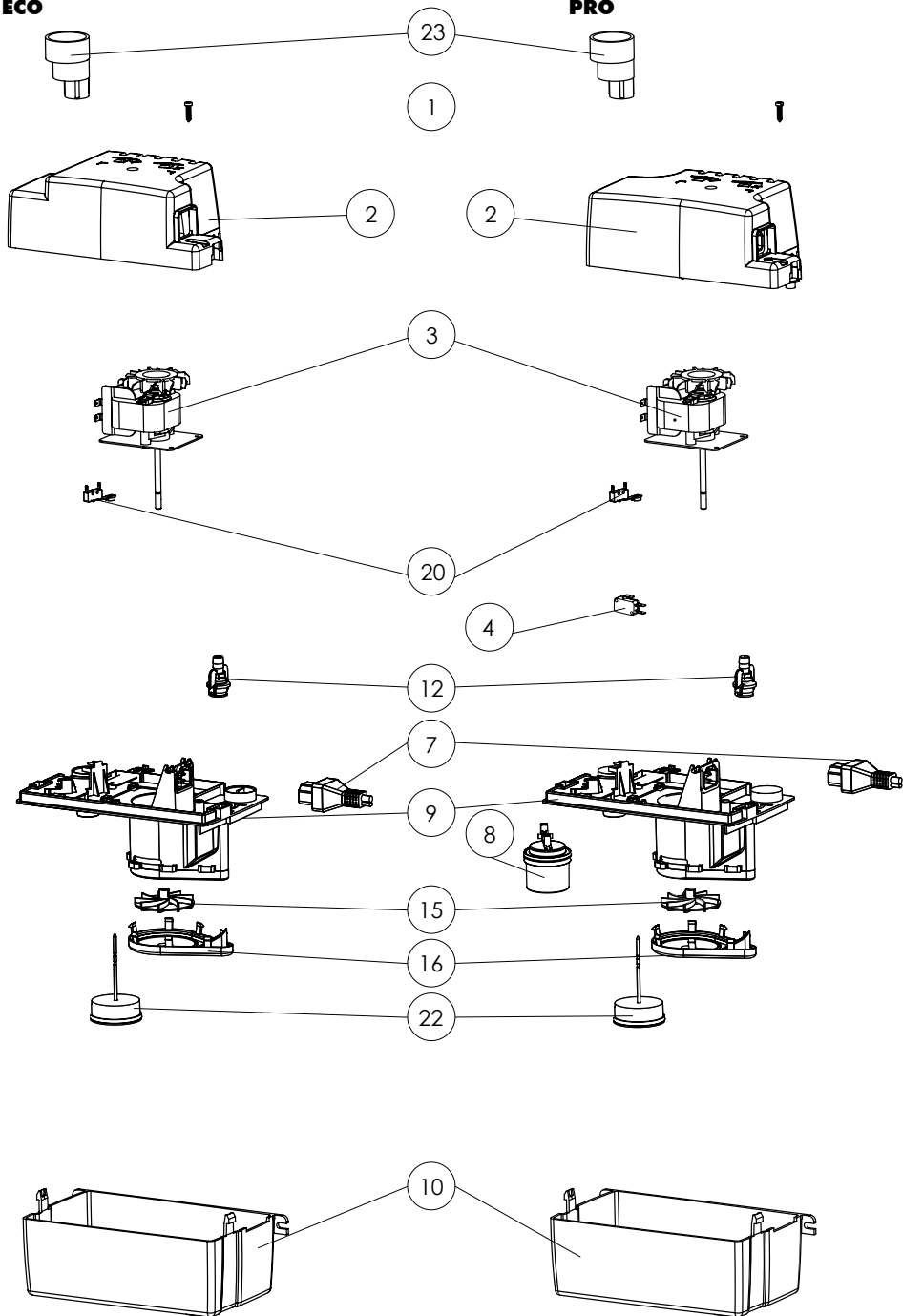

1. SAFETY

Identification of warnings

⚠ DANGER High risk of danger, due to voltage, which can lead to death or serious injury, if not avoided.

⚠ NOTICE Danger to the machine and its proper operation.

⚠ DANGER Disconnect electrical supply before working on the unit!

2. DESCRIPTION

2.1 AREA OF APPLICATION

Sanicondens* Pro/Eco is a pump used to lift condensation water from an air conditioning system, a condensation boiler, dehumidifiers or from refrigeration units.

Sanicondens* Pro will cope with blow off from domestic condensing boiler (<50kW) and will take PRV output, **but not from commercial boiler or unvented cylinder.**

If necessary, insert a neutralisation device (see your boiler manufacturer's instructions).

⚠ NOTICE The use of a neutraliser is mandatory on oil boilers in order to preserve the pump.

The pump starts automatically and has a high level of performance, safety and reliability as long as all the installation and maintenance instructions mentioned in this manual are strictly followed.

⚠ NOTICE All applications other than those described in this manual are prohibited.

2.2 OPERATING PRINCIPLE

Sanicondens* Pro/Eco contains a pump. The tank of the **Sanicondens* Pro/Eco** has a built-in a float which controls the operation of the motor. When the condensate enters the tank, the pump starts up.

Sanicondens* Pro has also a built-in secondary float that can trigger an alarm (audible and/or visual).

2.3 TECHNICAL DATA

Type	CD 10
Max. vertical pumping	4.5 m
Maximum flow rate	380 L/h
Min. pH	2.5
Level ON/OFF	56 mm/ 46 mm
Voltage	220-240 V
Frequency	50 Hz
Current consumption	0.52 A
Power rating	60 W
Electrical class	I
Protection index	IP24
Sound level	< 45 dBA
Average operating temperature	35 °C
Maximum allowable temperature	80 °C S3 15% (1min30 ON/ 8min30 OFF)

Weight of the unit	2 kg
Tank volume	2.2 L
Supply cable	1.5 m
Discharge hose	5 m, Øint: 10mm
Sanicondens* Pro: Alarm cable (2 cores)	1.5 m
Max. power for the connected boiler	gas: 50 kW oil: 30 kW
Wall mounting	Yes

2.4 LIST OF PARTS SUPPLIED see pg. 10.

2.5 DIMENSIONS see pg. 14.

2.6 PERFORMANCE CURVES see pg. 14.

2.7 VERTICAL PUMPING/HORIZONTAL PUMPING
see pg. 14.

3. INSTALLATION

Example of an installation of a **Sanicondens* Pro/Eco**: see pg. 10.

3.1 FITTING

⚠ NOTICE Always install the pump:
- horizontally, using a leveling tool,
- as close as possible to the appliance keeping in mind that the condensate has to drain through gravity into the pump.
To ensure proper ventilation of the motor, the pump must be free of any obstruction.

The pump can be mounted against a wall using the plastic anchors **B** and screws **C** supplied (accessory bag). See fig. **2-4**.

Check that the **Sanicondens* Pro/Eco** is leveled: fig. **2**.

3.2 HYDRAULIC CONNECTION

Connecting the inlet

The pump has two inlets Ø28 mm that can be used as required (fig **1**):

- The left inlet is open.
- The right inlet is protected by a break-off plug. To use the right inlet, first cut out the cut-off plug with a cutter and remove it.

Drain the condensate water to any of these inlets (fig **5**). If necessary, use a rubber flexible adapter **A**.

Connecting the discharge pipe

The **Sanicondens* Pro/Eco** discharge connection must be connected to the flexible vinyl hose **D**.

- Unroll the flexible hose **D**.
- Insert the hose into the discharge connection that has a built-in non-return valve (see fig. **6**).
- Position the flexible hose in the upmost vertical position possible to avoid any kinking. It is recommended to make a smooth turn to avoid the hose from kinking.
- Secure the hose by using the clamp **E** supplied (fig. **6**).

The hose has an inner diameter of 10 mm and can be connected to a PVC pipe of larger diameter by a plastic reducer connection **F** (fig. **6.1**). Provide a cable tie to secure the connection (fig. **6.2**).

The **Sanicondens* Pro/Eco** is fitted with a non-return valve to prevent re-activation.

3.3 CONNECTING THE ALARM (Sanicondens* Pro)
Sanicondens* Pro is fitted with a detection system that can cut off the power supply to the connected

appliance if the water level rises too high.

IMPORTANT The connection of the detection system to the safety system of the connected appliance is mandatory. The guarantee does not cover damage caused if the alarm is not connected.

INSTRUCTIONS FOR QUALIFIED PROFESSIONALS ONLY:

To connect the detection system, connect the other set of cables, black and grey (see «Alarm» label), to the appliance (refer to the instructions of the appliance). See fig. 8.

NOTE: It is possible to connect the detection system to an external alarm (audible or visual, from 1.5 V to 230 V) by changing the connection of the detection system. **Sanicondens® Pro** is controlled by a dry contact supplied NC (normally closed). To connect the external alarm, this contact must be changed to NO (normally open, fig. 11). To do this, open the cover (fig. 9), unplug the grey wire from its location and plug it to the free contact above (fig. 10).

NOTICE The maximum current admissible for our detection system is 4 A.

To protect the electrical components in the **Sanicondens® Pro**, once the alarm has been triggered, any water continuing to fill the tank comes out through the overflow outlets of the tank.

3.4 MAINS CONNECTION

DANGER Ensure the electricity is turned OFF at the main switch board before wiring to connector.

Connect the power cable **G** to the **Sanicondens® Pro/Eco** (fig. 7) and then to the main power. Comply with local installation requirements.

4. USE

Functional test

IMPORTANT Before turning on the pump, make sure you remove the protective lock pin from the rear of the device (see p. 10).

- Pour water into the tank.
- Check that the pump starts and stops when the water level drops.
- **Check that there are no leaks in the connections.**

Sanicondens® Pro/Eco is ready to use.

5. STANDARDS

Sanicondens® Pro/Eco conforms to the European directive on low voltage.

6. INTERVENTIONS

DANGER Disconnect electrical supply before working on the unit!

6.1 MAINTENANCE

This device does not require any special maintenance.

6.2 TROUBLESHOOTING

INSTRUCTIONS FOR QUALIFIED PROFESSIONALS ONLY:

Fault detected	Probable causes	Action needed
The pump doesn't start.	The pump is not connected to the power supply.	Plug in the unit.
	The lock pin has not been removed.	Remove the lock pin.
	The unit is not leveled.	Check the unit with a leveling tool.
	Power outage.	Check the main power.
	Float blocked.	Clean the tank.
The pump does not lift.	Condensates inlet pipe blocked.	Clean the inlet pipe.
	Discharge pipe blocked.	Clean the discharge pipe.

7. DISPOSAL



The device must not be disposed of as household waste and must be disposed of at a recycling point for electrical equipment. The device's materials and components are reusable. The disposal of electrical and electronic waste, recycling and recovery of any form of used

appliances contribute to the preservation of our environment.

8. GUARANTEE

Sanicondens® Pro/Eco is guaranteed for 2 years for parts and labour, subject to correct installation and use of the unit.