

# Technical Specification Sheet

## ADOUR CH

Twin lever mixer tap

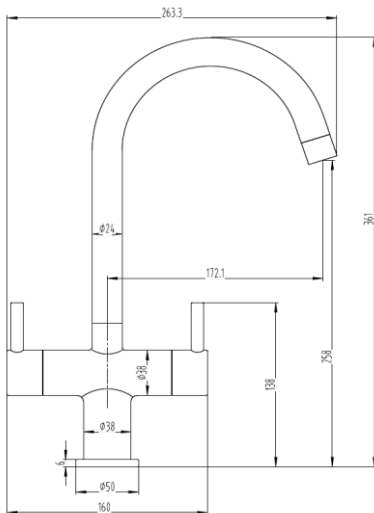

### Specification

Finish	Chrome
Body	Brass , Stainless Steel
Fitting	fixation kits/inlet hoses
Connections	
Spout Rotation (°)	360

### Dimensions

Tap Hole Size (mm)	35
Height (mm)	361
Base Width (mm)	50
Reach (mm)	172
Weight (kg)	1.2
Box Dimensions (mm)	390 x 200 x 60
Packed Weight (kg)	2

### Bar Pressure

Minimum Pressure	0.5
Maximum Pressure	5
Maximum Static Pressure	8
Maximum Temperature (°C)	70

### Flow Rates

@ 0.1 bar	@ 0.5 bar	@ 1 bar	@ 3 bar
n/a	5.5 L/m	8.1 L/m	14.5 L/m

### Additional Features/Benefits

All pressures are in bar.  
 Dimensions supplied are nominal and subject to tolerance.  
 Inclusion of aerator (if supplied) or restrictors (supplied separately) will affect flow rate result.  
 Performance details are based on trials under test conditions and are for guidance only,  
 The manufacturer reserves the right to change product specification without prior notice.

EAN Number 506916361812

### Warranty

10 Year Warranty (Casting Only)

### Care & Maintenance

Reginox recommends cleaning your tap regularly with non-abrasive cleaners. Warm, soapy water would be best.

### Certifications