

INSTRUCTION MANUAL

Plain Mirror

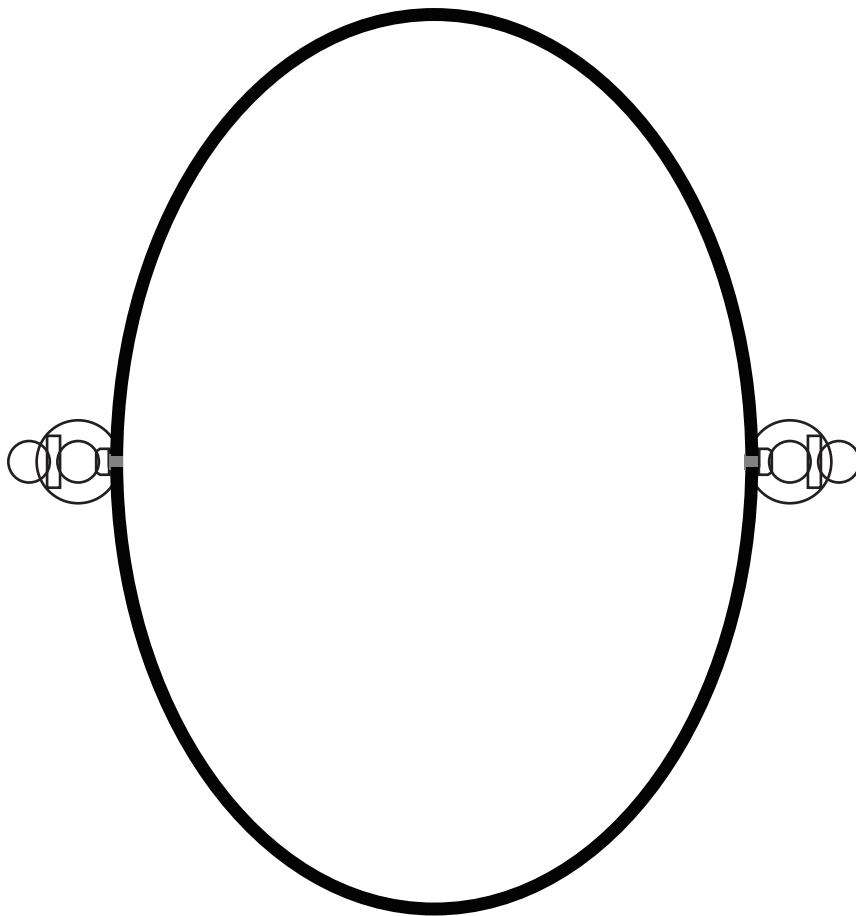

SKU:TRADMIRCHR/TRADMIRBB

Hanging the mirror

Installation Tools

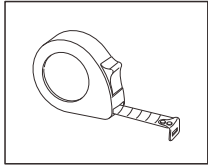

Measuring tape

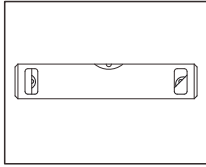

Spirit level

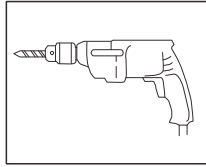

Drill

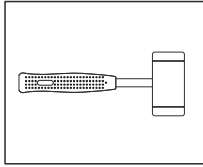

Hammer

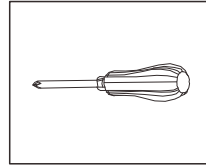

Screwdriver

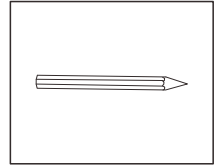

Pencil

Installation Steps

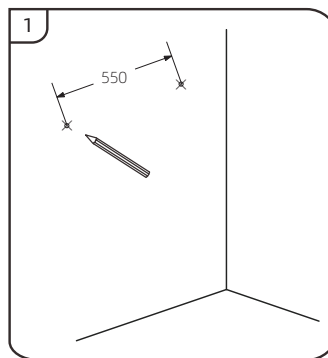
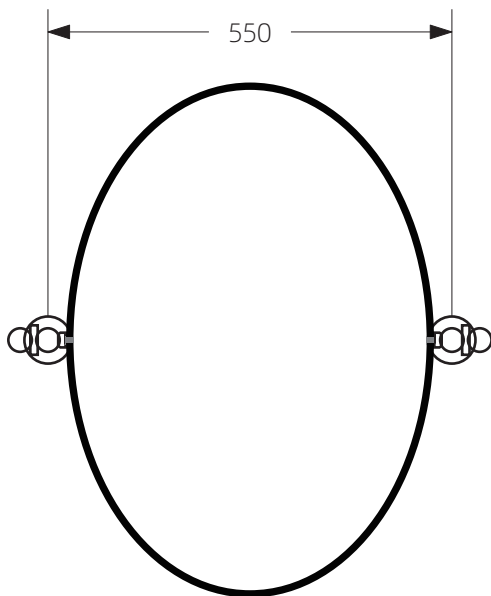

Make sure the wall is solid and suitable for safely supporting the overall weight of the mirror once installed. Use a pencil to measure and mark the positions of the mirror nails, securing screws, and Rawl plugs. At the same time, use a spirit level to ensure the bracket is perfectly level.

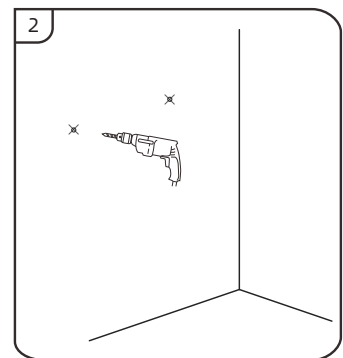

Select a $\Phi 8$ drill bit and drill holes in the marked area to a depth of 50mm. (If the wall is tile, use a special ceramic drill).

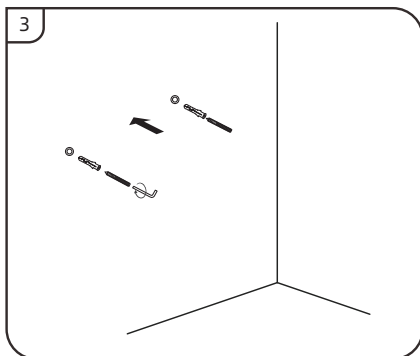

Insert Rawl plugs into drilled holes and use a hex wrench to fix the M6 * 60 double headed self tapping screw to the wall.

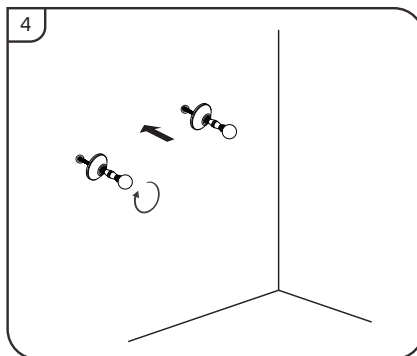

Fix the base onto M6 * 60 double headed self tapping screws.

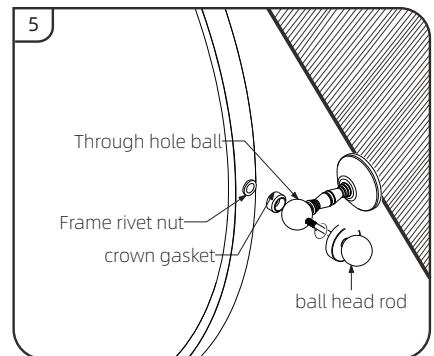

Screw the ball head rod through the through hole ball and crown gasket into the rivet nut of the frame. Do the same on the other end of the frame.

Recycling and disposal

Please recycle the packaging in accordance with your local government regulations on waste handling, and follow the same advice at the end of the products life.