

Geberit Monolith sanitary module for floor-standing WC, 114 cm, front cladding made of stoneware

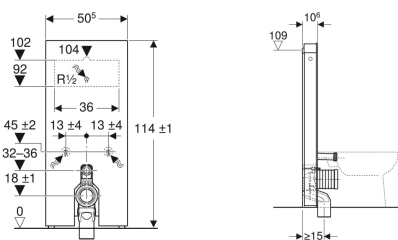

Example image



Application purposes

- For floor inlets
- For renovations, conversions and new buildings
- For wall inlets with an inlet height of 18 cm
- For replacing floor-standing WCs with concealed cistern with maximum service opening height < 109 cm
- For replacing low-level exposed cisterns
- For replacing half-high level exposed cisterns
- For replacing floor-standing WCs with close-coupled exposed cistern
- For connecting Geberit AquaClean Tuma WC complete solution, floor-standing WC
- For connecting Geberit AquaClean WC enhancement solutions, with accessories
- For replacing pressure flushing valves
- For mounting on finished floors
- For installation in front of drywalls or solid walls

Characteristics

- Dual flush

Scope of delivery

- Water supply connection set with 2 angle stop valves, 1/2"
- Flush bend extension 160 mm
- Connection bend made of PP, ø 90 mm
- Sleeve made of EPDM, ø 44 / 55 mm
- Adaptor socket made of PE-HD, ø 90 / 110 mm
- Fastening material
- Base cover
- Fastening material for drywall

- Compensation of dimensional tolerances possible
- Cistern, fully insulated against condensation
- Side cladding made of aluminium brushed
- Self-supporting
- Adjustable flush volume
- Water supply connection on the rear centre
- Water supply connection on the left/right possible with accessories
- Water supply connection on the bottom

Technical data

Flow pressure (bar) - min. to max.	0.1–10 bar
Operating temperature, water (°C) - max.	25 °C
Flush volume, factory setting (l)	6 / 3 l
Flush volume large, adjustment range (l)	4.5 / 6 l
Flush volume small (l)	3 l
Calculated flow rate (l/s)	0.11 l/s
Minimum flow pressure for calculated flow rate (bar)	0.5 bar

Art. no.	Publication.ColourSurface	B / width (cm)	H / height (cm)	T / depth (cm)
131.033.00.5	Front cladding: Stoneware slate look Side cladding: black chrome aluminium	50.5 cm	114 cm	10.6 cm
131.033.JV.5	Front cladding: Stoneware concrete look Side cladding: aluminium	50.5 cm	114 cm	10.6 cm

Accessories

- Set of fixing bolts made of aluminium, for Geberit Monolith side cladding
- Conversion set for Geberit AquaClean WC enhancement solutions
- Lateral water supply connection set for Geberit Monolith sanitary module for WC



- The colour and structure of natural products may vary