

*Dual Outlet Shower Head Kit*

Plumbing Systems and Water Pressure

All products are suitable for all UK Water Authority supply pressures. If the product is installed at low pressure (tank fed) then the minimum height from the outlet of the shower head to the underside of the cold tank should be 1.8 metres to ensure adequate performance.

This product should be installed in accordance with the current Water Regulations. Any claims that may arise will be dealt with on the basis that isolating valves are fitted.

Water Pressure:

We recommend a minimum water pressure of 0.5 Bar and a maximum of 5 Bar to ensure efficient operation of your product.

Cleaning/General Care

Chrome and Gold plated finishes should be cleaned with warm water and a soft cloth, rinsed and then immediately buffed with a dry soft cloth. Under no circumstances must any aggressive or abrasive cleaning agents be used. The use of any abrasive agents or materials will invalidate the guarantee.

Customer Care Helpline

Telephone: 01386 800750

Email: [customerservices@plumbworld.co.uk](mailto:customerservices@plumbworld.co.uk)

Installation Guide

1. Use hexagon wrench to loosen the nut from the bottom of riser rail.
2. Open both of the cover caps from top and bottom of brackets. Use screwdriver to loosen the bolts.
3. Move the rail and holder away from the fixing brackets and mark the drill hole position through the bracket onto the wall.
4. Drill holes to a depth of 45mm into the wall.
5. Fix the top bracket into required place. Then fix the bottom bracket into required place.
6. Put the rail through the top bracket, then put the handshower holder back on to the rail. Then feed the rail through the bottom bracket.
7. Adjust the rail into the required place. Then use the bolts to lock the two brackets. Insert the cover caps into the brackets.
8. Screw the nut back onto the bottom of riser rail. Connect the diverter to the bottom of riser rail. Then Connect the shorter hose to the bottom of diverter and the other end of shorter hose to the shower valve or tap.
9. Connect one end of the longer shower hose to the diverter and the other end of the shower hose to the handshower. Put the handshower in the holder.
10. Screw the top shower head to the top of the rail.

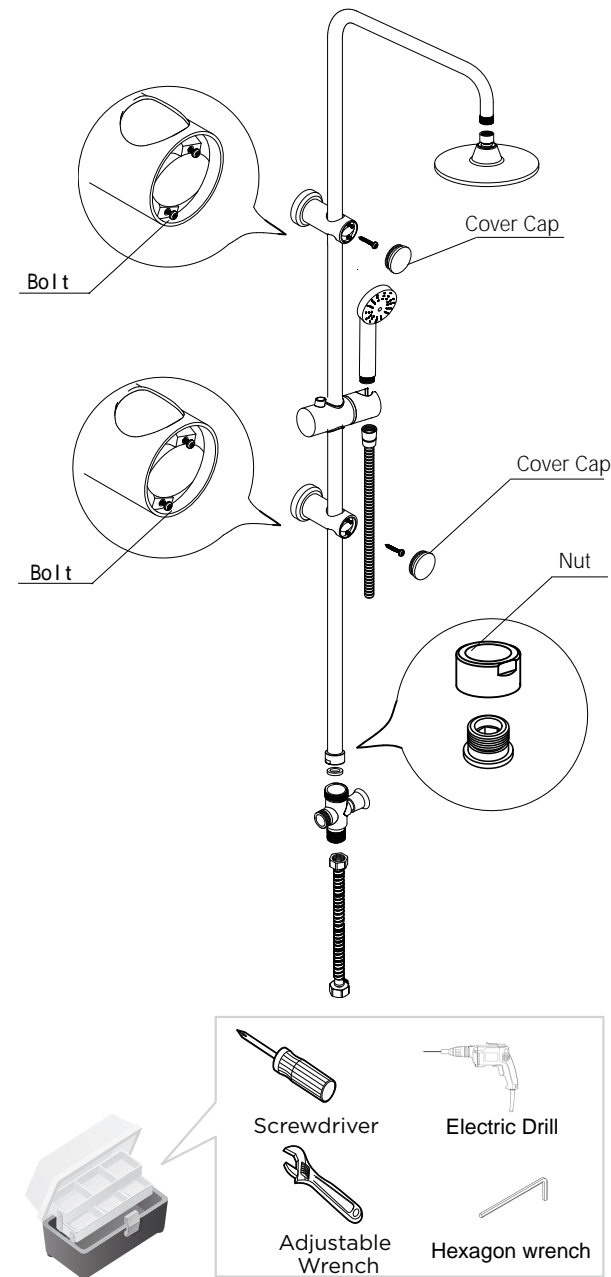

## **Check out our full range of Showers**

Electric Showers

Digital Showers

Mixer Showers

Power Showers

Smart Showers

Shower Towers

## **From Top Shower Brands**

Mira Showers

Aqualisa Showers

Triton Showers

Gainsborough Showers

## **Shower Pumps can upgrade your showering experience even more**

Stuart Turner Shower Pumps

Salamander Shower Pumps

Grundfos Shower Pumps

**plumbworld**  
**Big brands, small prices.**