

# Installation Guide

# 102.002

Riser Kit with Rectangular Soap Dish

## Spare Parts

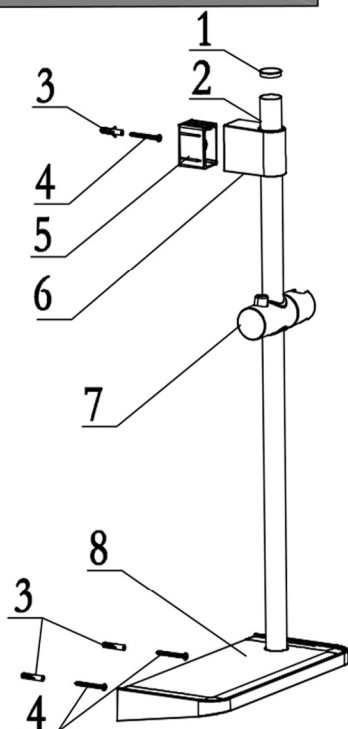

NO.	Items	Qty
1	Cover	1
2	Sliding Bar	1
3	Wall Plug	3
4	Fixing Screw	3
5	Wall Bracket	1
6	Wall Bracket Cover	1
7	Adjustable Shower Holder	1
8	Shelf	1

\* Replace wall plugs with appropriate hollow wall fixing if securing to stud wall.

## 1. Holes Drilled Position

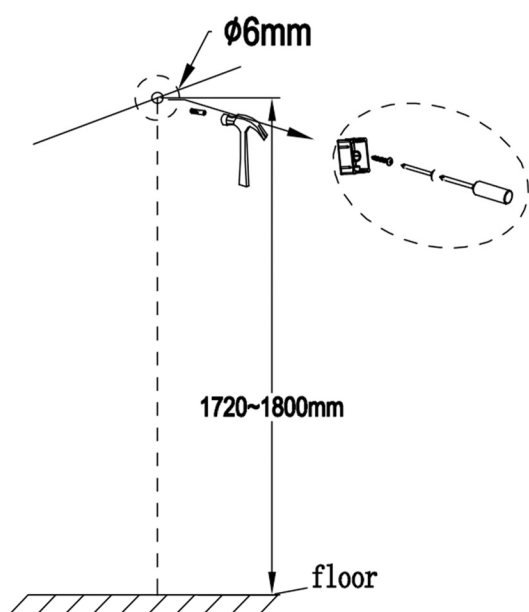

1. Drill a wall hole with driller 6# and fix wall plug;
2. Install wall bracket on wall with provided screw installation

## 2. Sliding Bar Installation

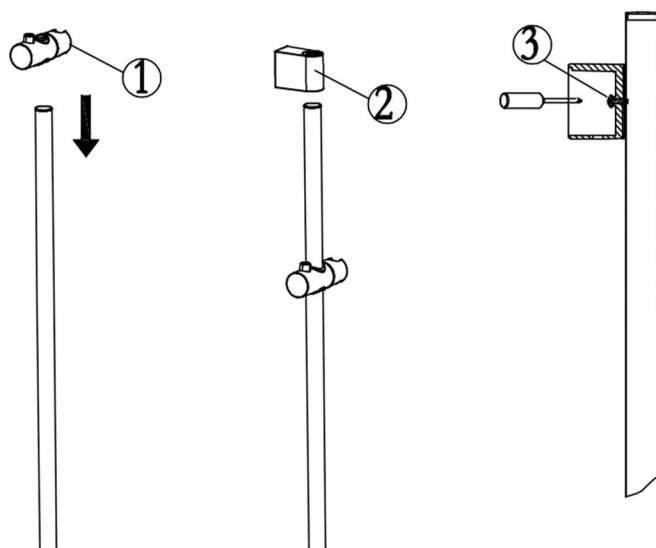

1. Put adjustable shower holder(1) into sliding bar
2. Put the sliding bar into wall bracket cover(2)
3. Tighten sliding bar and wall bracket cover with fixing screw(3)

**Eastbrook** 

Eastbrook Road, Gloucester GL4 3DB

Technical Helpline : 01452 317890

Mon - Fri / 8am - 5pm

Email : [technical@eastbrookco.com](mailto:technical@eastbrookco.com)

**This product should be fitted by a fully qualified installer.**

### 3.Wall Mounted Installation

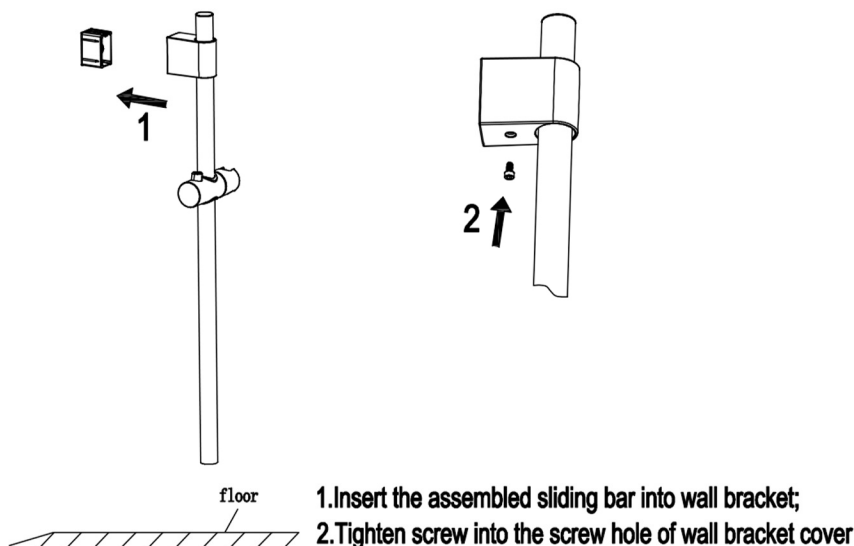

### 4.Wall Mounted Installation

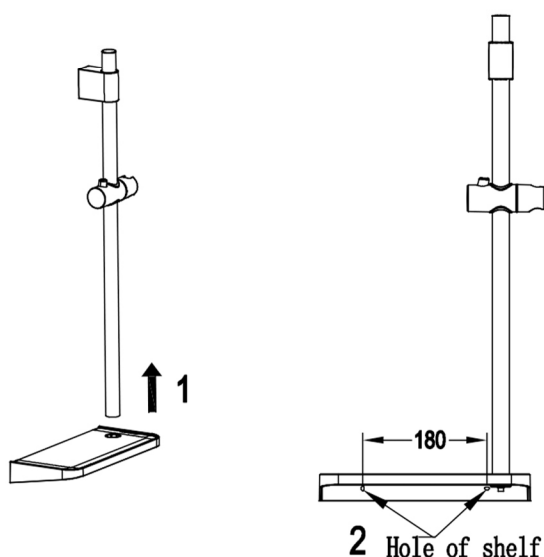

### 5.Wall Mounted Installation

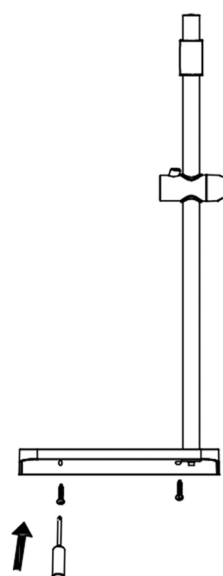

#### CLEANING

This product should only be cleaned with soapy water and rinsing with clean water and drying with soft cloth. We do NOT recommend to use any household cleaners to clean this product.

**Warranty is conditional with the product being maintained in accordance with the cleaning instructions and ensuring no parts are broken or loose to prevent failure.**

**This product should be fitted by a fully qualified installer.**

**Eastbrook** 

Eastbrook Road, Gloucester GL4 3DB

Technical Helpline : 01452 317890

Mon - Fri / 8am - 5pm

Email : [technical@eastbrookco.com](mailto:technical@eastbrookco.com)