



#### Great results in half the time

The 6000 CombiQuick® CombiOven uses hot air circulation with microwave technology to provide cooking in half the time without sacrificing flavour. You can also grill, roast and bake – all in one.

#### Product Benefits & Features



#### Microwave with Hot Air. For better and faster heating

Microwave with Hot Air provides dual functions – microwave and convection cooking, which merges hot air circulation and advanced microwave technology with turntable so your food is cooked faster and more evenly.



#### EXPlore. Easy access to your oven's functions

EXPlore allows you to effortlessly control the settings of your oven to know what's happening with your cooking. With the LED display, 5-touch buttons and 2 rotary knobs, you can easily see the time, temperature and progress of your dish.



#### Cooked Evenly everywhere

The clever Hot Air convection system ensures hot air circulates evenly throughout the oven cavity, for a cooking process that is faster, and more energy efficient.

#### Grill function. For faster browning and grilling

Perfect for toasts or crispy dishes, the Grill function is highly efficient to toast, crisp or brown your dishes to precision.

- Multifunction
- Retractable Oven controls with LED display
- Fast heating
- Electronic temperature control
- Automatic safety oven switch-off
- Residual heat indicator
- Cooling fan

Product Specification

Main Colour	Stainless Steel with antifingerprint coating
Cavity Size (L)	44
Cleaning	Clean enamel
Plug or Hardwired	Hardwired connection only
Functions (Main Oven)	True fan cooking, Conventional/Traditional cooking, Turbo grilling, Pizza setting, Turbo grilling + Microwave, True fan cooking + Microwave, Defrost, Reheating, Microwave, Grill (menu), Bottom heat (menu), Frozen food (menu), Conventional cooking + microwave (menu), Grill + microwave (menu)
Product Number (PNC)	ER Open
Dimensions (mm) (HxWxD)	455x594x567
Built-in Dimensions (mm) (HxWxD)	450x560x550
Timer Type	LUX
Voltage (V)	220-240
Total Electricity Loading (W)	3000
Series	6000
Frequency (Hz)	50
Cord Length (m)	1.5
Temperature Range	30°C - 230°C
Maximum Microwave Output (W)	1000

Main Oven - Shelves Included	1 Wire shelf chromed
Main Oven - Trays Included	1 Dripping pan grey enamel, 1 Trivet chromed
Main Oven - Shelf Support	Side grids Easy entry

PSGBOV230DE00001

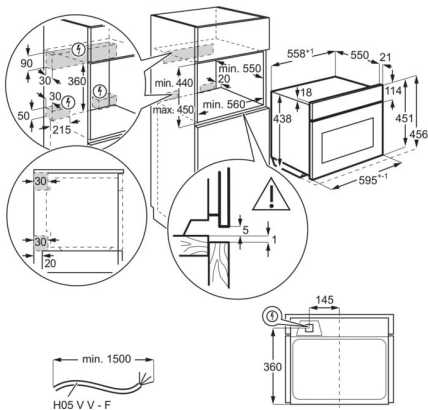

PSGBOV230DE00002

