



SHOWERS

T100xr slimline electric shower specification



BS EN 60335
KM 52019

T100xr slimline electric shower

The T100xr is the prestige model of the **XR** family. With a slimline design and a brushed chrome fascia, its stunning good looks will fit into any stylish bathroom. It offers power selector buttons for High/Economy/Cold settings with a push start/stop button featuring phased shutdown.

style and finish options

T100xr electric shower available with a showerhead and riser rail
White/Chrome

- **Slimline design** with a brushed chrome fascia
 - **STOP button** with phased shutdown
 - **Power selector start buttons** for selection of: Cold/Economy/High
 - **Temperature control**
 - **'Power On' indicator**
 - **'Low pressure' indicator** operates when the water pressure is insufficient
 - **Stylish chrome curved riser rail** with soap dish
 - **Rub-clean showerhead** 5 spray patterns
- **Power rating**

240v	230v	MCB Protection Device
8.5kW	7.9kW	40 Amps
9.5kW	8.8kW	40 Amps
10.5kW	9.6kW	45 Amps
 - **Replacement installation trim (available separately)** for help with top pipe entry installations and for replacing electric showers from a variety of manufacturers



T100xr
Slimline electric shower
8.5kW - SP1008XR
9.5kW - SP1009XR
10.5kW - SP1001XR

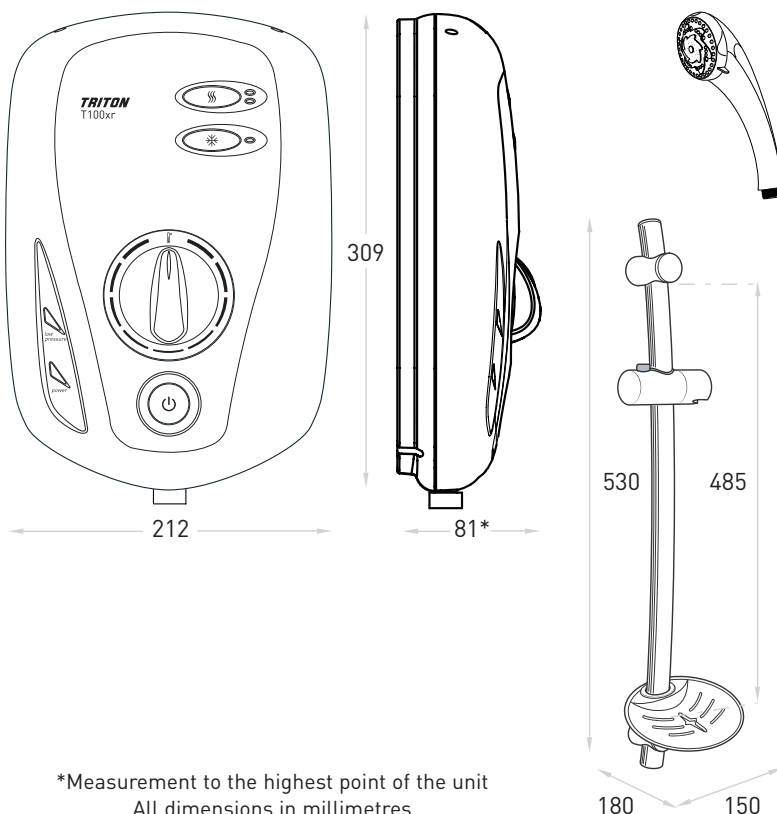

*Measurement to the highest point of the unit
All dimensions in millimetres

Temperature / flow rate

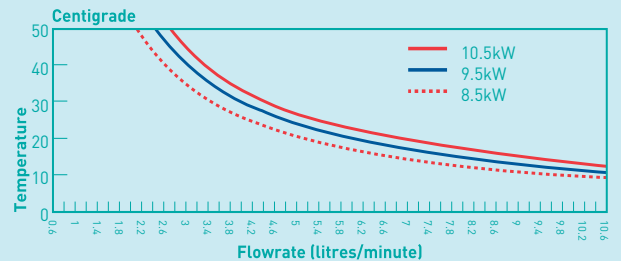

Note: The approximate temperatures indicated are based on 0°C ambient incoming water temperature. This can vary between 3°C and 23°C depending on weather conditions

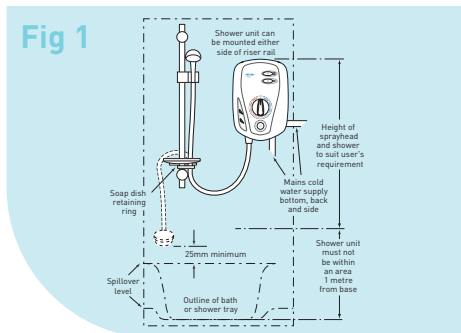
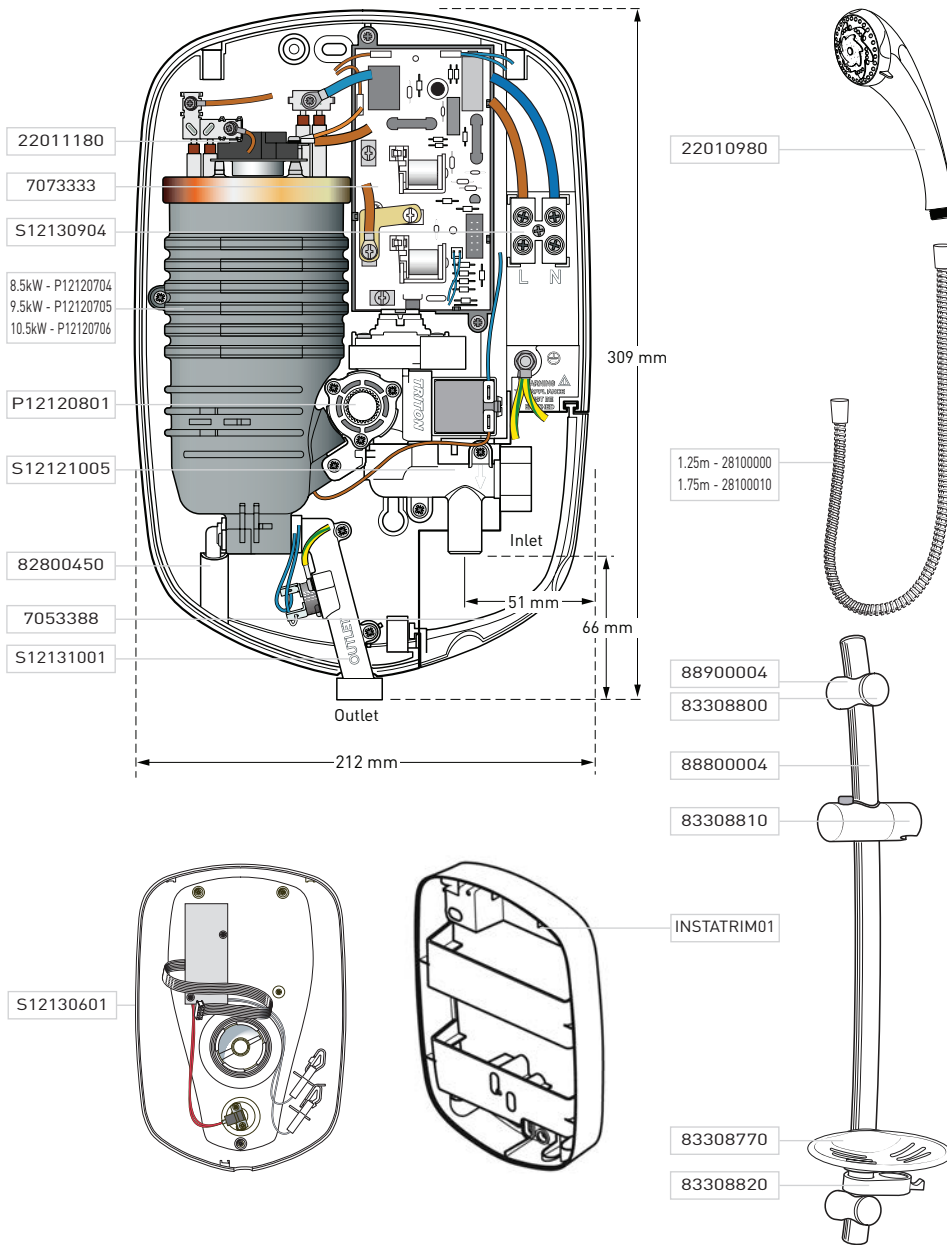

SITING OF THE SHOWER

Important: If installing onto a tiled wall always mount the unit on the surface of the tiles. NEVER tile up to the unit. Position the unit where it will NOT be in direct contact with water from the showerhead. Position the shower unit vertically. Allow enough room between the ceiling and the shower to access the cover top screws. Leave enough space between the left-hand side of the unit and the wall to allow access to the pressure relief device (PRD) in the future.

Note: Water regulations require the showerhead to be 'constrained by a fixed or sliding attachment so that it can only discharge water at a point not less than 25mm above the spill-over level of the relevant bath, shower tray or other fixed appliance', see Fig.1. The use of the supplied gel hanger/hose guide will in most cases meet this requirement, but if the showerhead can be placed within a bath, basin or shower tray, then a double check valve, or similar, must be fitted in the supply pipework to prevent back-flow.

Pressure relief safety device: A pressure relief device (PRD) is designed into the shower unit which complies with European standards. The PRD provides a level of appliance protection should an excessive build up of pressure occur within the shower. DO NOT operate the shower with a damaged or kinked shower hose, or a blocked showerhead which can cause the PRD to operate. When commissioning, the showerhead must be removed from the flexible hose, while at the same time the temperature control must be at the minimum flow position. Failure to follow this procedure may also cause the PRD to operate. Make sure the shower is positioned over a bath or shower tray because if the PRD operates, then water will eject from the bottom of the unit. Should this happen, turn off the electricity and water supplies to the shower at the isolating switch and stopvalve. Contact Customer Service for advice on replacing the PRD.

WARNING! The shower must not be positioned where it will be subjected to freezing conditions.

IMPORTANT: The unit must be mounted on a flat surface which covers the full width and length of the backplate. It is important that the wall surface is flat otherwise difficulty may be encountered when fitting the cover and subsequent operation of the unit may be impaired.

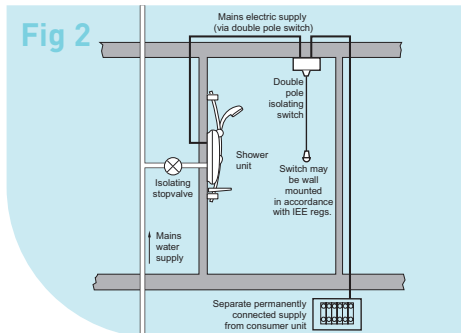

WATER REQUIREMENTS

The installation must be in accordance with Water Regulations/Byelaws. To make sure of activating the heating elements, the shower must be connected to a mains water supply with a minimum running pressure of 100kPa (1.0 bar) at a minimum flow rate of nine litres per minute. The maximum static pressure must be no greater than 1 000kPa (10 bar).

Note: For the 10.5kW rated shower the minimum running pressure must be 150kPa (1.5 bar) at a minimum flow rate of eleven litres per minute with a maximum static pressure no greater than 1 000kPa (10 bar).

Note: If the stated flow rates are not available, it may not be possible to achieve the best performance from the unit throughout the year. For guidance on the running and static pressures contact the local water company or consult a competent plumber. During periods of high ambient temperatures it may be necessary to select a low power setting to achieve your preferred shower temperature. The water supply can be taken from a cold water storage cistern provided there is a minimum head of ten metres (fifteen metres for the 10.5kW rated shower) above the showerhead. It must be an independent supply to the shower only. If it is intended to operate the shower at pressures above the maximum or below the minimum stated, contact Customer Service for advice. Fig.2 shows a typical system layout.

DO NOT use jointing compounds on any pipe fittings for the installation.

APPROVALS

Products conform to EU New Approach Directives i.e Low Voltage directive and EMC directive.

T100xr PART NUMBER	DESCRIPTION	S12130601	Cover assembly
7073333	Power PCB	INSTATRIM01	Replacement installation trim (optional) - white
S12130904	Terminal block		
22011180	Thermal cut-out		
	Heater can assembly		
P12120704	8.5kW	RISER RAIL PART NUMBER	DESCRIPTION
P12120705	9.5kW	88900004	Kit (without riser rail)
P12120706	10.5kW	83308790	Brackets & trims (pair)
P12120801	Stabiliser valve/solenoid assembly	83308800	Trim (single)
	PRD & 'O' ring	88800004	Riser rail
S12121005	Inlet pipe assembly	83308810	Sprayhead holder
S12131001	Outlet pipe assembly	83308770	Soap dish
7053388	Trimplate	83308820	Hose retainer
7053386	Drip shield	28100000	1.25m flexi hose - chrome
		28100010	1.75m flexi hose - chrome
		SPRAYHEAD PART NUMBER	DESCRIPTION
		22010980	Sprayhead



SHOWERS

A NORCROS Company

To contact Triton's Technical Advice Team, please call

+44 (0) 24 7632 5491

Triton Plc, Shepperton Park, Triton Road, Nuneaton, Warwickshire CV11 4NR
Tel: +44 (0) 24 7634 4441 Fax: +44 (0) 24 7634 9828 www.tritonshowers.co.uk

It is our policy to improve the design and specification of our products and we reserve the right to depart from the details given without prior notice.

plumbworld
Big brands, small prices.

Pdf Supplied By <http://www.plumbworld.co.uk/>