



SHOWERS

# T100E thermostatic care electric shower specification



BS EN 60335  
KM 52019

## T100E Thermostatic Care electric shower

A new thermostatic option of the UK's most popular care shower. The slim design, easy to use temperature control dial and large start/stop button make this an ideal shower for all the family, care professionals and local authorities

style and finish options

T100E Thermostatic Care available with a care pack  
White/Chrome

- **Thermostatic control** ensures that the temperature does not increase by more than 1.5°C of the setting
- **Adjustable maximum temperature** prevents temperature from being turned up too high. Can be set between 35°C and 47°C
- **Push button Start/Stop** large button located at the bottom of the unit
- **Phased Shutdown**
- **Push button power selectors** common household symbols for ease of use
- **Numbered temperature dial** a shaped and tactile dial for easy temperature selection
- **'Low Pressure' Indicator** operates when the water pressure is insufficient
- **'Power on' indicator**
- **Extended riser rail (1m)** Allows the showerhead to be positioned for use both in a seated or standing position
- **Soft spray option** A multi spray pattern showerhead suitable for those with sensitive skin
- **Control extension levers** Essential for people with arthritic hands.
- **Power rating**  
240v 230v MCB Protection Device  
8.5kW 7.9kW 40 Amps
- **Reinforced high quality extended hose (1.75m)**  
Prevents kinking whilst allowing optimum manoeuvrability of the showerhead for the carer when assisting someone to shower.



T100E THERMOSTATIC CARE  
Electric shower  
C10E084T

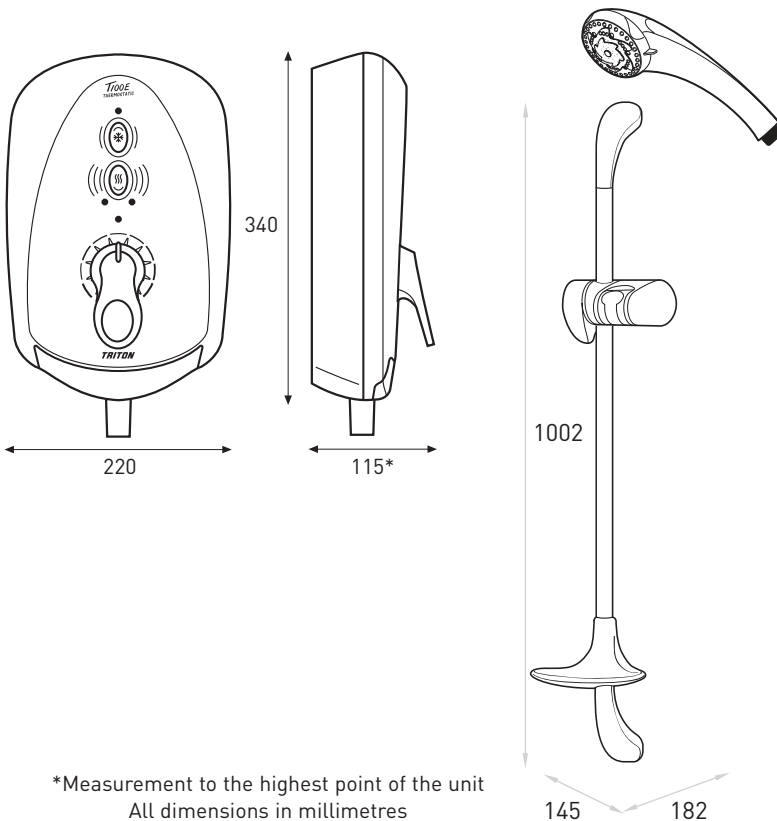

\*Measurement to the highest point of the unit  
All dimensions in millimetres

## Temperature / flow rate

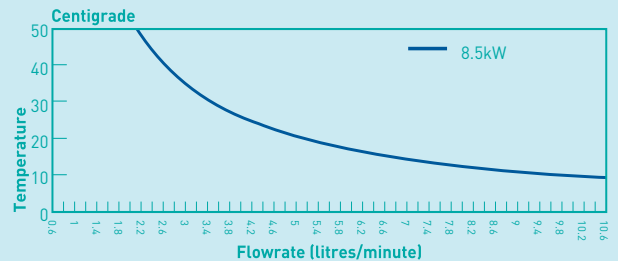

Note: The approximate temperatures indicated are based on 0°C ambient incoming water temperature. This can vary between 3°C and 23°C depending on weather conditions

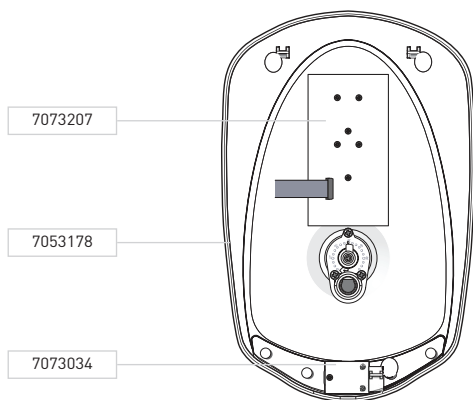
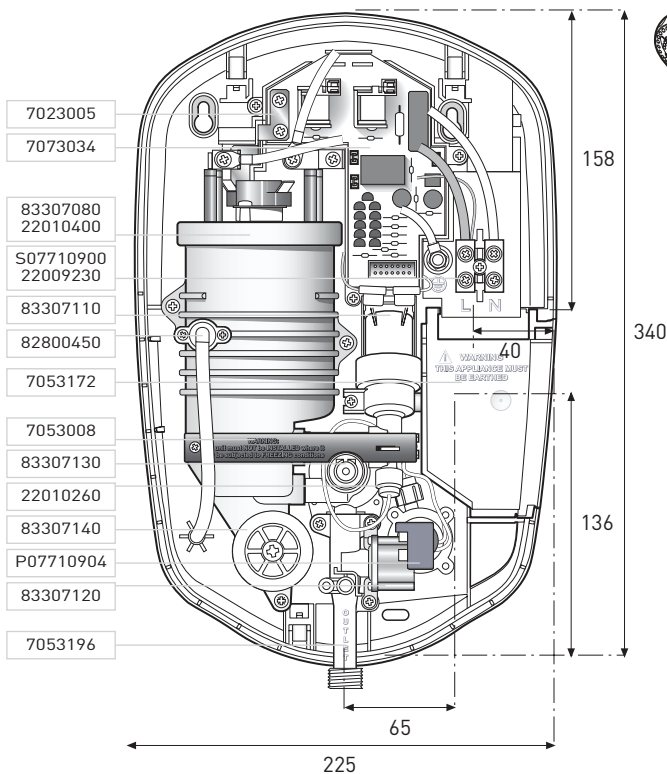

T100E THERMOSTATIC CARE PART NUMBER	DESCRIPTION
7073034	Printed circuit board
7023005	Copper bus bar
507710900	Terminal block & wires
22009230	Terminal block
83307080	Heater can assembly 8.5kW c/w restrictor & TCO
22010400	Restrictor 8.5kW
83307110	Solenoid valve assembly and 'O' ring
82800450	Pressure relief device
7053172	Trimplate
7053008	Can brace
83307130	Thermostatic valve & 'O' rings (4)
22010260	Connecting tube
83307140	Scale trap cover c/w 'O' rings and screw
7053196	Outlet pipe assembly

P07710904	Pressure switch microswitch & wires
83307120	Pressure switch & 'O' ring
507730600	Complete cover assembly
83307150	Wire set - 2 x earth & 1 x solenoid wires
7052991	Power PCB cover
7063046	Rubber microswitch cover
7053009	Inlet filter
7073207	Control PCB
7073034	Start/Stop PCB
7053178	Cover

RISER RAIL PART NUMBER	DESCRIPTION
83306160	Rail brackets
7042935	Extended riser rail
83306190	Sprayhead holder
22008960	Soap dish - white
28100020	1.75m flexi hose - chrome

SPRAYHEAD PART NUMBER	DESCRIPTION
22010980	Sprayhead - white

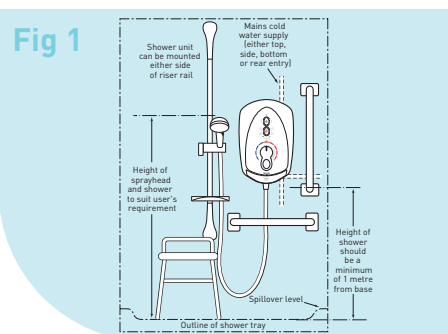
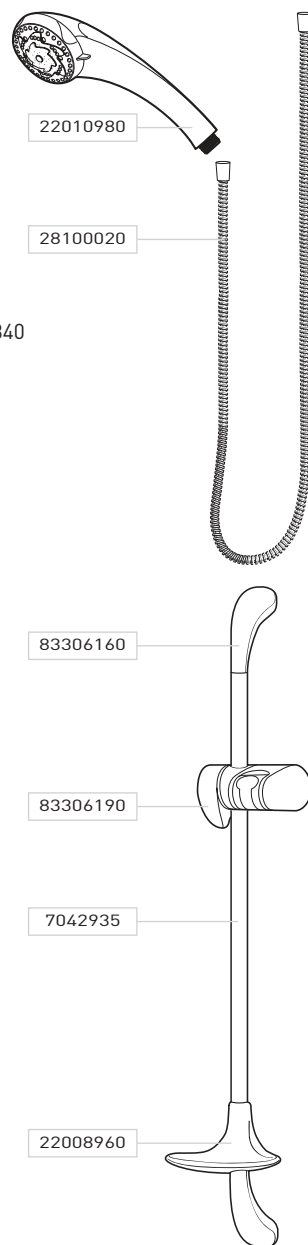

## SITING OF THE SHOWER

**Important:** If installing onto a tiled wall always mount the unit on the surface of the tiles. NEVER tile up to the unit. Refer to Fig.1. for the correct siting of the shower. Position the unit where it will NOT be in direct contact with water from the sprayhead. Position the shower unit vertically. Allow enough room between the ceiling and the shower to access the cover top screws.

**Note:** Water regulations require the sprayhead to be 'constrained by a fixed or sliding attachment so that it can only discharge water at a point not less than 25mm above the spillover level of the relevant bath, shower tray or other fixed appliance'. Because of the nature of the extended hose and riser rail, the sprayhead would normally be able to be placed within a bath, basin or shower tray. In this case a double check valve, or similar, must be fitted in the supply pipework to prevent back-flow.

**Pressure relief safety device:** A pressure relief device (PRD) is designed into the shower unit which complies with European standards. The PRD provides a level of appliance protection should an excessive build up of pressure occur within the shower. DO NOT operate the shower with a damaged or kinked shower hose, or a blocked sprayhead. This can cause the PRD to operate. Make sure the PRD outlet at the bottom of the unit is not blocked. When commissioning, the sprayhead must be removed from the flexible hose. Failure to follow this procedure may cause the PRD to operate. Make sure the shower is positioned over a bath or shower tray because if the PRD operates, then water will eject from the bottom of the unit. Should this happen, turn off the electricity and water supplies to the shower at the isolating switch and stopvalve. Contact Customer Service for advice on replacing the PRD.

**WARNING!** The shower must not be positioned where it will be subjected to freezing conditions.

**IMPORTANT:** The unit must be mounted on a flat surface which covers the full width and length of the backplate. It is important that the wall surface is flat otherwise difficulty may be encountered when fitting the cover and subsequent operation of the unit may be impaired.

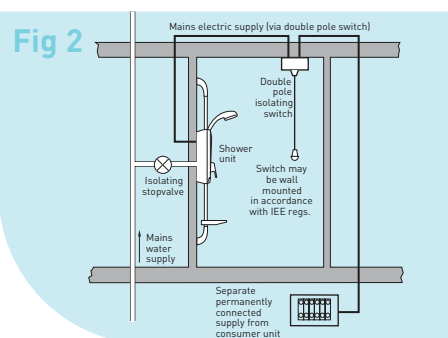

## WATER REQUIREMENTS

The installation must be in accordance with Water Regulations/Byelaws. To ensure activation of the heating elements, the shower must be connected to a mains water supply with a minimum running pressure of 100kPa (1.0 bar) at a minimum flow rate of nine litres per minute with a maximum static pressure of 1000kPa (10 bar).

**Note:** If the stated flow rates are not available, it may not be possible to achieve optimum performance from the unit throughout the year. Under site conditions where the power supply is below 220 volts and the mains water pressure is above 5 bar, it is recommended to fit a pressure reducing valve set at 3.5 bar. Fig.2 shows a typical system layout.

**DO NOT use jointing compounds on any pipe fittings for the installation.** During periods of high ambient temperatures it may be necessary to select a low power setting to achieve your preferred shower temperature. The water supply can be taken from a cold water storage cistern provided there is a minimum head of ten metres above the sprayhead. It must be an independent supply to the shower only. If it is intended to operate the shower at pressures above the maximum or below the minimum stated, contact Customer Service.

## APPROVALS

Products conform to EU New Approach Directives i.e. Low Voltage directive and EMC directive.

# TRITON

SHOWERS

A **MORCROS** Company

To contact Triton's Technical Advice Team, please call

**+44 (0) 24 7632 5491**

Triton Plc, Shepperton Park, Triton Road, Nuneaton, Warwickshire CV11 4NR  
Tel: +44 (0) 24 7634 4441 Fax: +44 (0) 24 7634 9828 www.tritonshowers.co.uk

It is our policy to improve the design and specification of our products and we reserve the right to depart from the details given without prior notice.