

# Franke Pro-Value Range Zurich Tap

## Installation Instructions

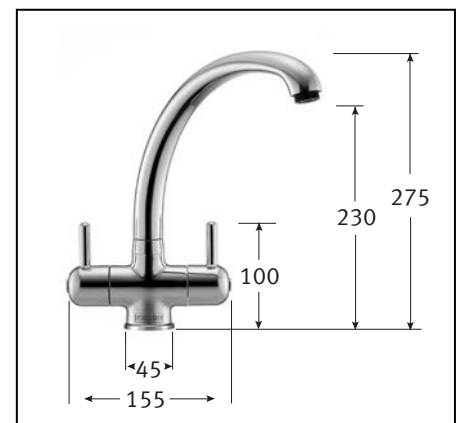

**FRANKE**

For kitchens without compromise.

KITCHEN  
SYSTEMS

## **Guarantee**

Your Franke mixer has been manufactured to the high standard you would expect of any Franke product but in the unlikely event that you should experience any defect in the materials or workmanship within one year of purchase, we will replace the faulty part free of charge. This is provided the mixer has only been used for normal domestic purposes in the UK and that the care, installation and maintenance instructions have been observed.

This one year guarantee is extended to five years in the case of the valve mechanism.

You should also retain your dated invoice as proof of purchase to validate any claims under our guarantee.

Normal wear and tear is excluded from the guarantee. Decorative surface finishes are guaranteed for one year from the date of purchase provided our advice concerning care has been observed and no scouring agents have been used.

Scuffs and scratches caused by improper installation or accidental damage are not covered by this guarantee. Neither are slight shade variations or any damage or defect caused by incorrect installation or abuse of the fitting.

## **Design**

These mixers are available in Chrome and SilkSteel to complement Franke Pro-Value sinks.

## **Service**

In the event of parts or service being required, please contact:

**Central Services** Telephone 01782 599 258 or

**South Services** Telephone 0844 800 3346

Please read these instructions before you install and use the tap. All designs, descriptions and dimensions are subject to change without notice.

## **Preparation**

First shut off your water heating system then, with your mains stop cock closed, open the lowest hot and cold taps in the house and allow to run until the cold storage tank and pipes are empty. (The hot water storage cylinder always remains full).

## **Installation**

First screw the threaded stud into the mixer body. Screw the copper tubes into the mixer body, and fully hand tighten. Place sink mixer in position to see if any alteration to the existing supply pipework is necessary.

After making any necessary alterations to the pipework, pass the rubber washer over the copper tubes and threaded stud to form a seal on sink top. Pass the copper tubes and fixing stud through the sink top from above, and place the mixer in position on the sink with the cold (normally) on the right hand side.

Slide the retaining plate up the copper tubes (ensuring that the raised side is positioned downwards with the 'O' ring in place) and to secure, screw the fixing nut finger tight. The 'O' ring will then fit between the plate and the sink.

Check that the mixer body is correctly positioned and fully tighten fixing nut.

The copper tubes at this stage will need to be gently turned outwards, then supported approximately half-way down and turned inwards, making the two pipes parallel again but further apart thus making room for the couplings to be fitted. It is recommended that 15mm x 15mm compression fitting be used to connect mixer to supply pipes. Hot water should be connected to the left when viewed from the front.

### Attention

Before installing the new mixer it is essential that you thoroughly flush through the supply pipes in order to remove any remaining swarf, solder or other impurities. Failure to carry out this simple procedure could cause problems or damage to the workings of the mixer. Having first checked all new connections, turn on the mains stop cock, close all taps except the new mixer and as the system starts to refill check for leaks.

### Warning

These hints have been prepared for your guidance, you must exercise due care at all times. We do not accept responsibility for any problems that may occur through incorrect installation.

### How to care for your kitchen sink mixer

Our mixers have been most carefully manufactured and their surfaces will maintain their appearance for a long time provided they are only cleaned with a soft cloth, soap and water. Under no circumstances should any abrasive liquid, powder or scouring pad be used.

To maintain the appearance of this fitting, ensure it is cleaned only using a clean, soft damp cloth. A solution of warm water and mild liquid detergent may be used where necessary, and then the fitting rinsed thoroughly. Abrasive cleaners or acidic cleansers **MUST NOT BE USED** under any circumstances. Avoid contact with all solvents. We recommend that your mixer is fitted by a qualified and registered plumber.

### Technical data

Maximum water pressure: 75 PSI (5 bar)  
Maximum hot-water temperature: 70°C  
Recommended hot-water temperature: 65°C

**Note: If these temperatures or water pressures are exceeded damage to the tap can result. A pressure reducing valve may be required to be fitted in high water pressure situations.**

### Recommended Parts List:

|         |                   |
|---------|-------------------|
| 1258R   | Spout             |
| 1256R   | Perlator          |
| 1244R   | Spout Fixing Bush |
| 1239R   | O-Ring Kit        |
| 3166R C | Cold Handle       |
| 3166R H | Hot Handle        |
| 1212R C | Cold Valve        |
| 1212R H | Hot Valve         |
| 1242R   | Fixing Kit        |
| 1234R   | Copper Tails      |

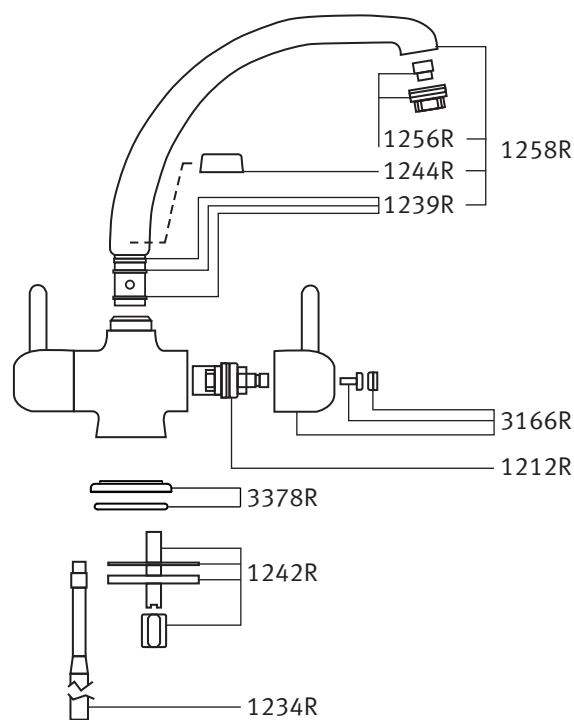

Franke UK Limited

West Park, MIOC

Styal Road

Manchester M22 5WB

**[www.franke.co.uk](http://www.franke.co.uk)**

Service & Spares:

**Central Services** 01782 599 258

[mail@central-servicesuk.co.uk](mailto:mail@central-servicesuk.co.uk)

[www.central-servicesuk.co.uk](http://www.central-servicesuk.co.uk)

**South Services** 0844 800 3346

[sales@south-services.co.uk](mailto:sales@south-services.co.uk)

[www.south-services.co.uk](http://www.south-services.co.uk)



KITCHEN  
SYSTEMS

**plumbworld**  
**Big brands, small prices.**

Pdf Supplied By <http://www.plumbworld.co.uk/>