

## WARNINGS AND PRECAUTIONS

- If the electricity supply fails, do not use the devices connected to the appliance.
- It is recommended that the appliance should have its own power socket.
- The appliance can discharge only faeces, toilet paper and acid fatty and hot water (up to 100 °C). Do not throw unsuitable objects that might damage the pump into the WC. For this reason, fix the sticker supplied to the underside of the toilet lid or in some other position where it is visible.
- Check that the items connected to the appliance are not leaking, since if they are, the pump will operate uselessly.  
Furthermore, in the event of a failure in the power supply, water leaking from some device could flow back up and might then overflow.
- In the event that the bathroom or house are not to be used for a long period, it is recommended that the mains water supply be closed.
- The pump is not damaged by detergents.

## REMOVAL OF THE EXTRACTABLE PART FOR FILTER-CLEANING

SPLIT-SYSTEM 1000 comprises an initial water-collecting unit fixed in a permanent manner onto the water closet and the other appliances, and a second extractable unit including the mechanisms needed for its operation.

The extractable part can be removed in a very simple operation as follows:

- 1. Disconnect the plug from the socket of the device.**
2. Remove the side cover as shown in Fig. 7.
3. Remove the plug provided for emptying the collection unit, collecting the water as shown in Fig. 8.
4. Unscrew the knob on the opposite side of the appliances as shown in Fig. 9.
5. Remove the extractable unit as shown in Fig. 10 and free the filter from any unsuitable object as shown in Fig. 11.
6. Insert the extractable unit and screw back the knob until the extractable unit is firmly connected to the water collection unit.

## INSTALLATION AND USE

The macerator-box SPLIT-SYSTEM 1000 consists of a box that incorporates a pump that can automatically chop and expel acid, fatty hot water (up to 100°C) faeces and toilet paper through a 32 or 40 mm diameter pipe to the nearest sewer.

It may be used to collect and pump under pressure up to a maximum height of 11 meters (refer to the performance-related graph) all the discharges of the sanitary fittings located in both the bathroom and the kitchen, including washing machine, dishwasher, and any other device that needs to discharge waste water.

The sanitary fittings referred to above may be connected with the pulverizing box all together, one at a time, or else in any combination of fittings as required.

### WATER CONNECTION

SPLIT-SYSTEM 1000 can be connected to any type of WC with a wall discharge to European standards.

It is connected by inserting the WC discharge into the rubber coupling on the tank and fixing it with the clip supplied (Fig. 1).

The outlet and other pieces of bathroom and kitchen equipment are connected to the back of the appliance (Fig. 2), so that all those pipes, connectors, valves etc. that inevitable spoil the appearance of a bathroom can disappear. However the possibility of connecting pipes externally exists (Fig.3, Fig.4 and Fig.5).

Bathroom and kitchen items must be connected as shown in Fig. 2. For dishwashers and washing machines only, one can select either of the two inlet connections.

**N.B.:** The shower plate and bathtub must be at least 20 cm above floor level (Fig. 6).

Fig. 1

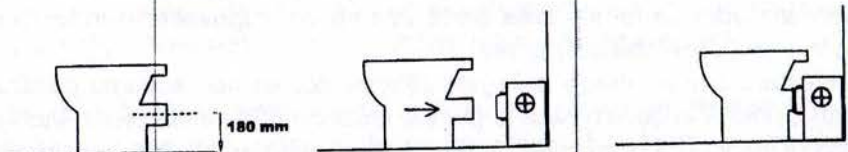

Fig. 2

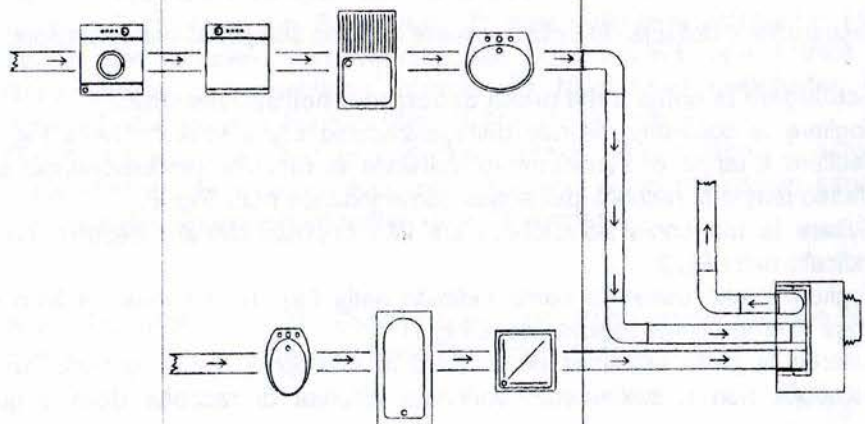

Fig. 3

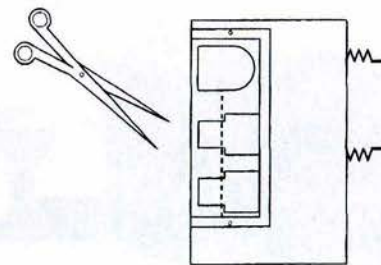

Fig. 4

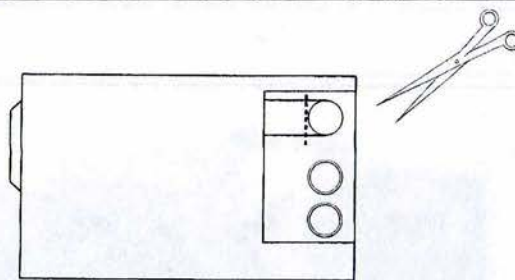
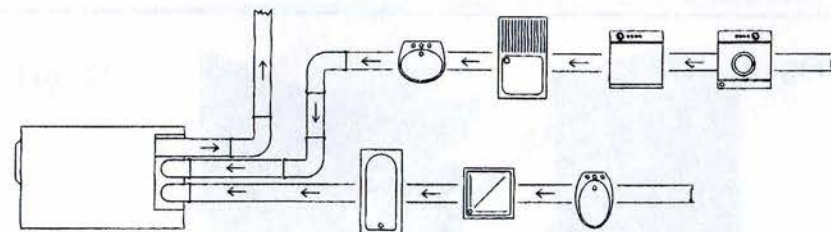

Fig. 5



CASSETTE-BROYEUR - MACERATOR BOX - KLEINHEBEANLAGE  
TOILETVERGRUIZER - CAJA-MACERADOR - CASSETTA TRITURATRICE

## MOD. 1000

### Specifications

Power supply	230 V ac
Power	1000 W
Electrical absorption	4 A
Frequency	50 Hz
Protection class	IP 55
Max elevation head	11 m
Max capacity	350 l/min
Service	Intermittent
Sewage water temperature	<100°C
Condenser	20πF/450V

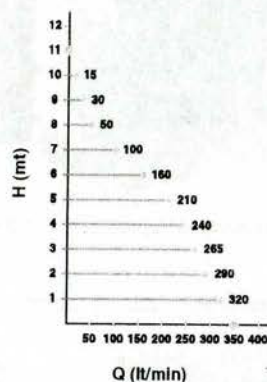

MOD. 1000 complies with the following standards:

Directive CE 89/392 - 89/336 - 73/23 - 93/68



### ELECTRICAL CONNECTION

All wirings must confirm to the rules of the institution of electrical engineers.

SANISPLIT requires a 230v. ac 50Hz single phase supply (U.K. specifications).

The appliance must not be connected to a conventional plug and socket.

SANISPLIT must be wired into a fused unswitched fixed wiring connector (only the type to be installed in the bathroom) fitted with a fuse 5A.

SANISPLIT is double insulated and also has the earth wire.

The wires of SANIPLIT are coloured in accordance with the following code:

**Brown = live**  
**Blue = neutral**  
**Green/Yellow = earth**

**plumbworld**  
**Big brands, small prices.**

Pdf Supplied By <http://www.plumbworld.co.uk/>